

WALK THE CUSTOMER THROUGH EACH OF THE FOLLOWING KEY DELIVERY FEATURES

- MANUAL / AUTOMATIC CLIMATE CONTROL – pages 18-21
 - Explain different air modes to a customer.

Manual



Automatic

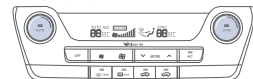

- DEFROST – page 18–20
 - Press the front defrost button.
 - Set to warmest temperature setting.
 - Set to highest fan speed.
- TIRE PRESSURE MONITORING SYSTEM (TPMS) – page 34

Explain TPMS function to customer.

 - When illuminated, one or more tires are under-inflated.
 - Blinks for approximately one minute then remains illuminated when there is a malfunction with the TPMS.
 - You can also check the individual tire pressures in the Information Display mode in the LCD cluster. Tire pressures are displayed in the cluster after a few minutes of driving.



- VEHICLE SETTINGS – page 14-17
 - Demonstrate vehicle settings in instrument cluster
 - Demonstrate navigation use, enter dealer address
 - Show radio presets

- BLUETOOTH – page 24
 - Demonstrate phone pairing
 - Refer to www.hyundaiusa.com/bluetooth
 - Demonstrate QR code



- BLUE LINK – pages 25-27
 - Assist with creating MyHyundai.com account
 - Assist with Blue Link enrollment
 - Show Blue Link Users Manual & tear out Voice Commands/Quick Tip Card
 - Encourage customers to press the Blue link button

MAINTENANCE

Unit: mile

Scheduled Maintenance	Normal Usage	Severe Usage*
Engine Oil and Filter (Nu 2.0 GDI)	Replace 7,500 or 12 mos.	Replace 3,750 or 6 mos.
Engine Oil and Filter (Gamma 1.6 T-GDI)	1st Replace 3,000 or 6 mos. Add. 5,000 or 6 mos.	Replace 3,000 or 6 mos.
Tire Rotation	Perform 7,500	Perform 7,500
Air Cleaner Filter	Inspect 7,500 Replace 30,000	Inspect Same As Normal Replace More Frequently
Vacuum Hose	Inspect 7,500	Inspect Same As Normal
Climate Control Air Filter (for Evaporator and Blower Unit)	Replace 15,000	Replace More Frequently
Air Conditioning Refrigerant	Inspect 15,000	Inspect Same As Normal
Brake Hoses & Lines	Inspect 15,000	Inspect Same As Normal
Drive Shafts & Boots	Inspect 15,000	Inspect 7,500
Exhaust Pipe & Muffler	Inspect 15,000	Inspect Same As Normal
Front Disc Brake / Pads, Calipers & Rotors	Inspect 15,000	Inspect More Frequently
Propeller Shaft (AWD)	Inspect 15,000	Inspect 7,500
Steering Gear Box, Linkage & Boots/ Lower Arm Ball Joint, Upper Arm Ball Joint	Inspect 15,000	Inspect More Frequently
Suspension Mounting Bolts	Inspect 15,000	Inspect Same As Normal
Brake Fluid	Inspect 30,000	Inspect Same As Normal
Fuel Filter	Inspect 30,000	Inspect Same As Normal
Fuel Lines, Fuel Hoses and Connections	Inspect 30,000	Inspect Same As Normal
Fuel Tank Air Filter	Inspect 30,000	Inspect Same As Normal
Rear Disc Brake / Pads, Parking Brake	Inspect 30,000	Inspect More Frequently
Vapor Hose, Fuel Tank & Fuel Filler Cap	Inspect 30,000	Inspect Same As Normal
Rear Axle Oil (AWD)	Inspect 37,500	Replace 75,000
Transfer Case Oil (AWD)	Inspect 37,500	Replace 75,000
Valve Clearance	Inspect 60,000	Inspect Same As Normal
Drive Belt (Alt, A / C)	1st Inspect 60,000 or 72 mos. Add. Inspect 15,000 or 24 mos.	Inspect Same As Normal
Spark Plugs (Nu 2.0 GDI)	Replace 105,000 or 84 mos.	Replace More Frequently
Spark Plugs (Gamma 1.6 T-GDI)	Replace 45,000 or 36 mos.	Replace More Frequently
Coolant	1st Replace 120,000 or 120 mos. Add. Replace 30,000 or 24 mos.	Replace Same As Normal
Automatic Transaxle Fluid	No check, No service required	Replace 60,000
Ecoshift Dual Clutch Transmission Fluid	Inspect 37,500 or 30 mos.	Replace 75,000
Intercooler, In / Out Hose, Air Intake Hose (Gamma 1.6 T-GDI)	Inspect 6,200	Inspect Same As Normal

*See Owner's Manual for details.

Looking for more detailed information? This Quick Reference Guide does not replace your vehicle's Owner's Manual. If you require additional information or are unsure of a specific issue, you should always refer to the vehicle's Owner's Manual or contact your authorized Hyundai dealer.

The information contained in this Quick Reference Guide was correct at the time of printing; however, specifications and equipment can change without notice. No warranty or guarantee is being extended in this Quick Reference Guide, and Hyundai reserves the right to change product specifications and equipment at any time without incurring obligations. Some vehicles are shown with optional equipment. Specifications apply to U.S. vehicles only. Please contact your Hyundai dealer for current vehicle specifications.

NP150-T2015
(Rev 07/09/15)
Printing 07/12/15

HYUNDAI TUCSON

Quick Reference Guide



www.hyundai.com



Roadside Assistance: **1-800-243-7766**
 Consumer Affairs: **1-800-633-5151**
 SiriusXM® Radio: **1-800-967-2346**
 Blue Link: **1-855-2BLUELINK**
(1-855-225-8354)

Table of Contents

GETTING STARTED

Engine Start / Stop Button	03
Front Seat Adjustment	04
Headrest Adjustment	05
Rear Seat Folding	05
Seat Belt Adjustment	05
Smart Key	02
Smart Liftgate	03
Power Liftgate Operation	02

FEATURES AND CONTROLS

Air Ventilation Seats	13
Child-Protector Rear Door Lock	11
Climate Control	18-21
Defrosting - Defogging	18-20
Driver's Main Controls	07
Fuel Filler Door	07
Headlights and Fog Lights	08
Homelink Wireless Control	12
Instrument Cluster	14-15
Instrument Panel Illumination	17
Interior Lights	11
LCD Display Modes	16
Panoramic Sunroof	10
Rear Parking Assist System	13
Rearview Camera	13
Seat Warmer	12
Steering Wheel Adjustment	06
Warnings and Indicators	17
Wiper and Washer	09

MULTIMEDIA

Blue Link Telematics System	25-27
Bluetooth Operational Tips	22-23
Bluetooth Phone Operation	24
Bluetooth Phone Pairing	24
Navigation	29-31
Steering Wheel Audio Control	22
Standard Radio	28
Voice Recognition Tips	23

DRIVING

Automatic Transmission	33
Autonomous Emergency Braking (AEB)	38
AUX, USB and iPod Port	31
AWD Lock	37
Blind Spot Detection System (BSD)	36
Cruise Control	38
Downhill Brake Control (DBC)	35
Drive Mode Integrated Control System	37
Eco Shift Dual Clutch Transmission	32
Electronic Stability Control (ESC)	35
Lane Departure Warning System (LDWS)	36
Tire Pressure Monitoring System (TPMS)	34

* Some vehicles may not be equipped with all the listed features.

Frequently Asked Questions

- Pair phone to your vehicle. Refer to page 24.
- Garage door opener set up. Refer to page 12.

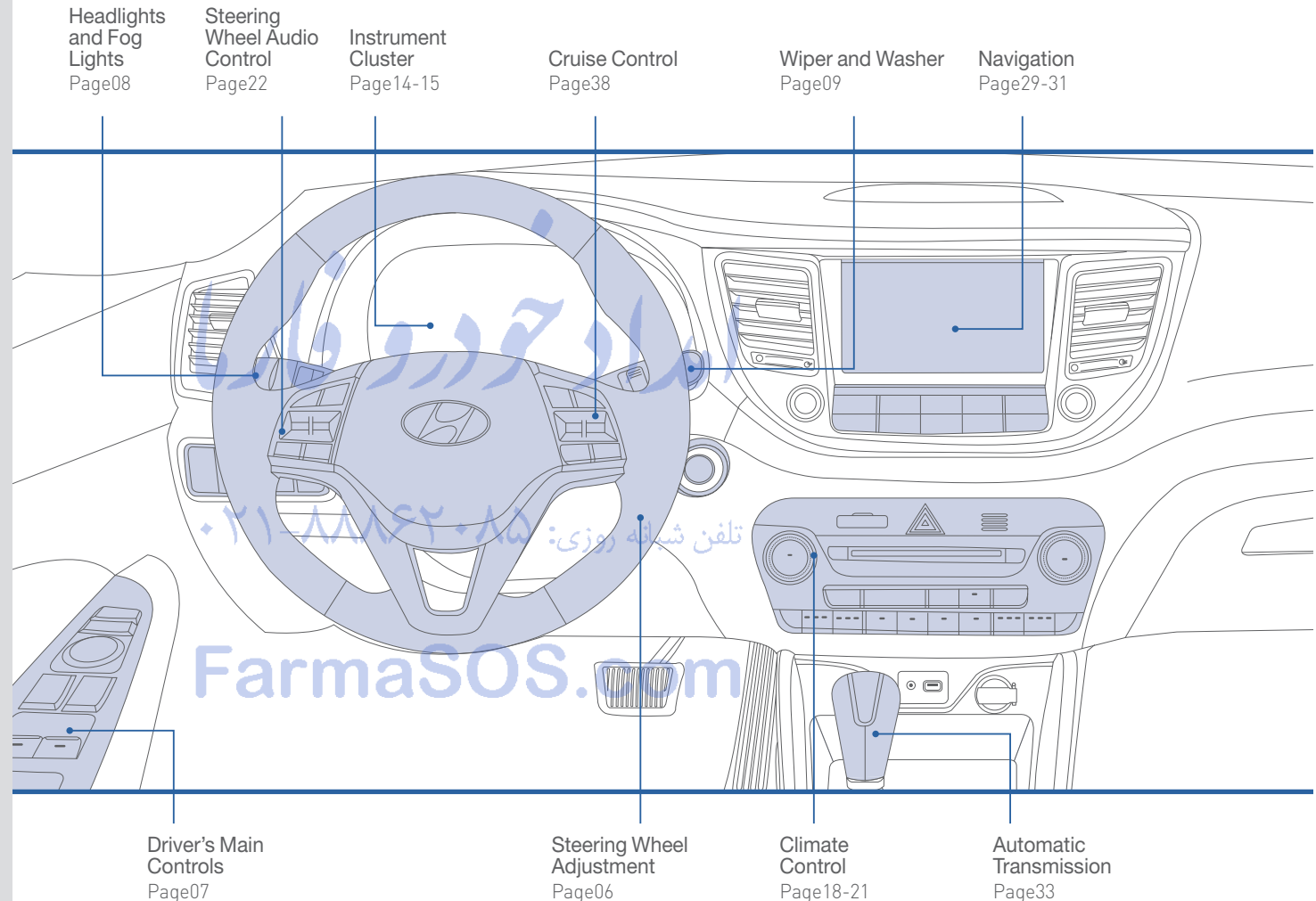

Use this Quick Reference Guide to learn about the features that will enhance your enjoyment of your Hyundai. More detailed information about these features are available in your Owner's Manual.

WARNING!

To reduce the risk of serious injury to yourself and others, read and understand the important SAFETY INFORMATION in your Owner's Manual.



GETTING STARTED



SMART KEY

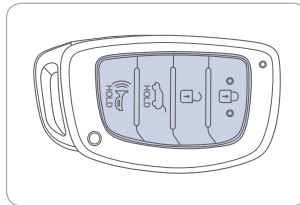

- Lock
- Unlock
- Liftgate Unlock
- Alert

NOTE :

For the User Selectable Option, please refer to your Owner's Manual for further information.

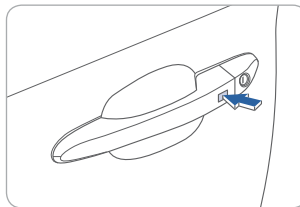

Driver's Door Lock / Unlock
Smart key must be within 28~40in. from the outside door handle.

- Press :** Once - Unlock driver door
Twice - Unlock all doors
Third - Lock all doors

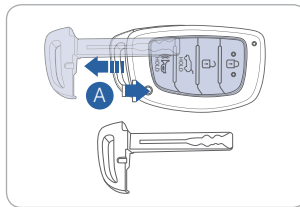

Removing the Mechanical Key
Press and hold the release **A** button and remove the key.

POWER LIFTGATE OPERATION

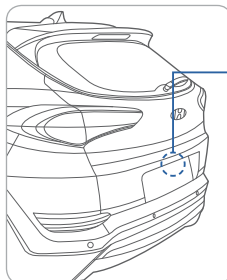

Press to open. Smart key must be within the range.

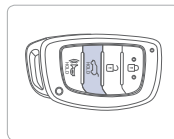

Press and hold to open.

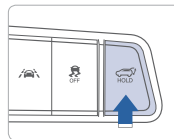

Press the power liftgate button in the vehicle.

SMART LIFTGATE

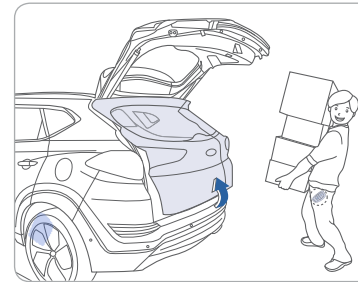

Approach the vehicle 15 seconds after all the doors are closed and locked with the smart key. The liftgate will open automatically.

ENGINE START / STOP BUTTON

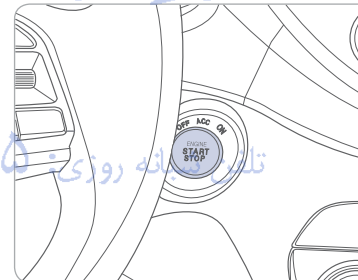

With the ignition OFF and foot OFF of the brake pedal, press the Engine Start / Stop button.

- Once for ACC (Accessory) mode.
- Twice for ON mode.
- Third for OFF.

To start the engine in any mode (including OFF), press the Engine Start / Stop button while pressing down on the brake pedal. To shut the engine OFF, place the shift lever in P (Park) and press the Engine Start / Stop button again.

Emergency Situations

Shutting Off the Engine while Driving

- Press the engine Start / Stop button for 2 seconds or more or 3 times consecutively within 3 seconds.

Restarting the Engine while Driving

- Press the engine Start / Stop button with the shift lever in N (Neutral).

GETTING STARTED

FRONT SEAT ADJUSTMENT (Manual)

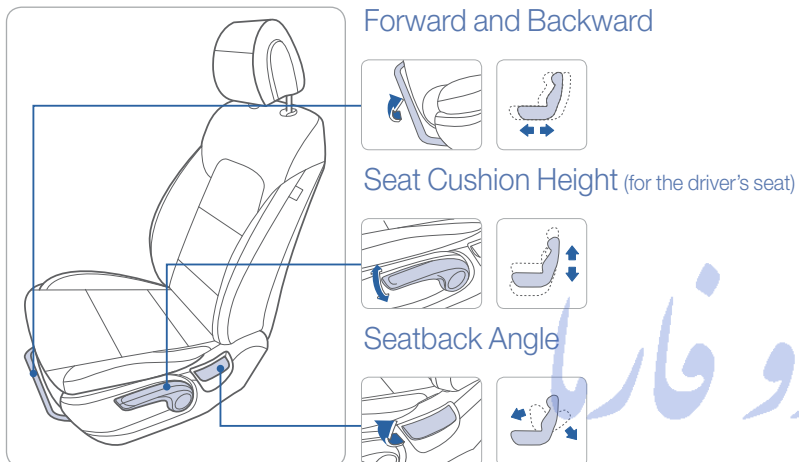

FRONT SEAT ADJUSTMENT (Power)

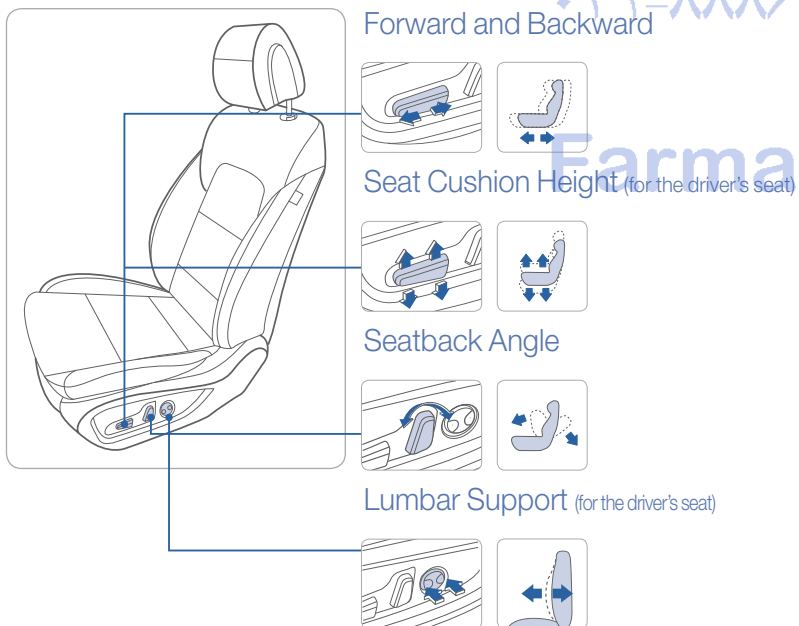

REAR SEAT FOLDING

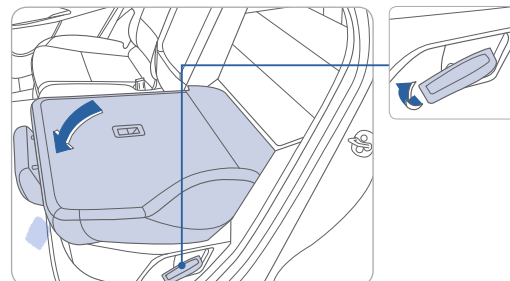

HEADREST ADJUSTMENT

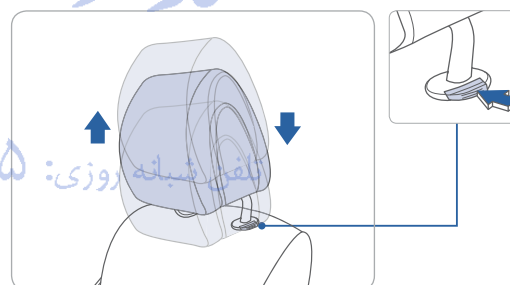

To Raise the Headrest:
Pull the headrest up.

To Lower the Headrest:
Press the lock button
while pressing down on
the headrest.

SEAT BELT ADJUSTMENT (Front seat)

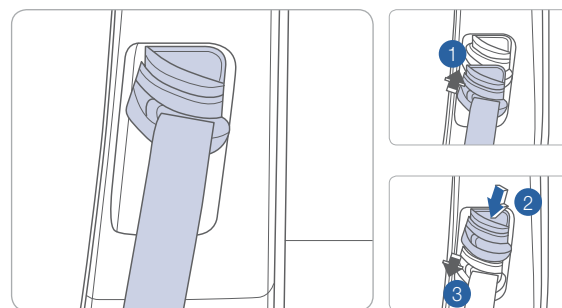

Pull up to raise.

Press the button
and push down
to lower.

FEATURES AND CONTROLS

STEERING WHEEL ADJUSTMENT

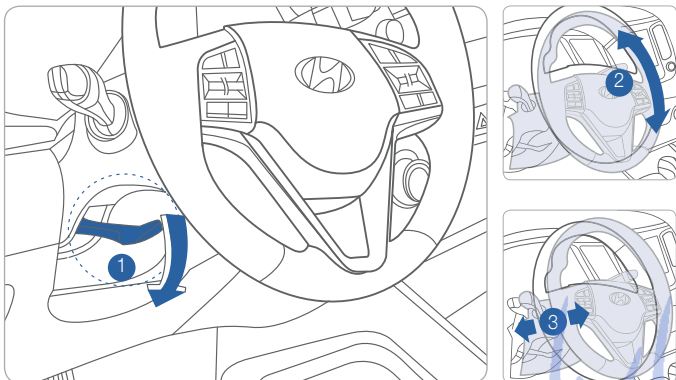

NOTE : Do not adjust while driving.

1. Pull down the lever ①.
2. Set the angle ② or the distance ③.
3. Pull the lever up.

FUEL FILLER DOOR

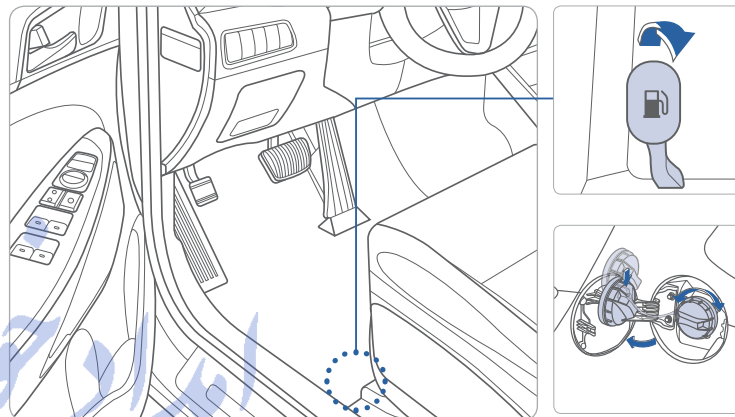

NOTE : Tighten until one click is heard.

تلفن شبانه روزی: ۰۲۱-۸۸۸۶۲۰۸۵

DRIVER'S MAIN CONTROLS

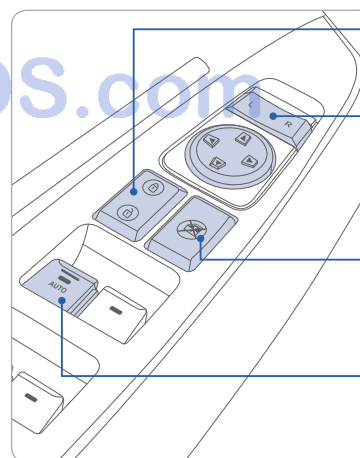

Door Lock

Locks / unlocks all doors.

Outside Rearview Mirrors

Press L (left) or R (right) on the switch. Adjust the mirror by using the mirror adjustment control switch.

Power Window Lock Switch

Disables the power window switches on the rear passenger doors.

Window Auto Up / Down (if equipped)

Press past detent to fully open / close the window.

FEATURES AND CONTROLS

HEADLIGHTS AND FOG LIGHTS

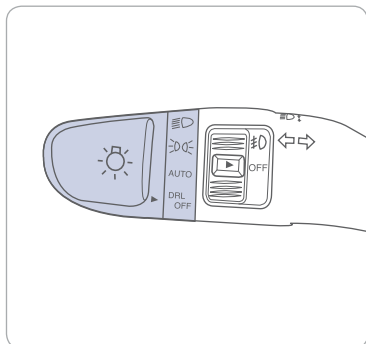

- ▶ Headlights ON
- ▶ Parking Lights ON
- ▶ **AUTO** Auto Headlight Mode ON
- ▶ **DRL OFF** DRL OFF

Headlights Delay

Headlights may stay on for 15 seconds after exiting and locking up the vehicle. Press the remote lock button twice to turn the headlights off. Please refer to your Owner's Manual for further information.

Turn Signals and Lane Change Signals

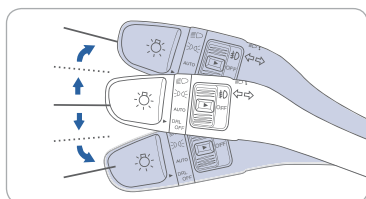

High Beams

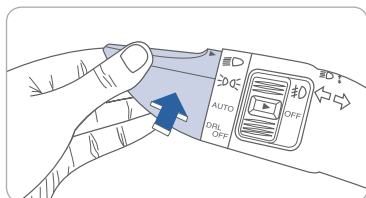

Flashing the Headlights

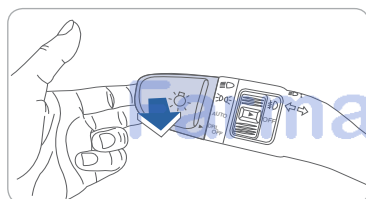

Fog Lights

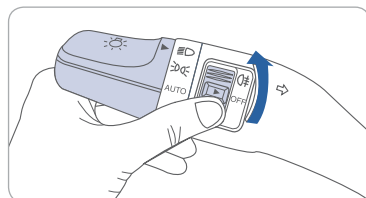

WIPER AND WASHER

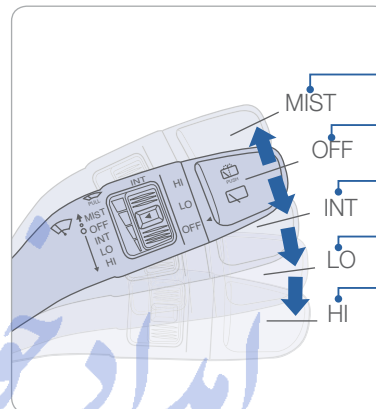

- MIST** - Single wipe
- OFF** - Off
- INT** - Intermittent wipe
- LO** - Low wiper speed
- HI** - High wiper speed

Intermittent Wipe Time Adjustment

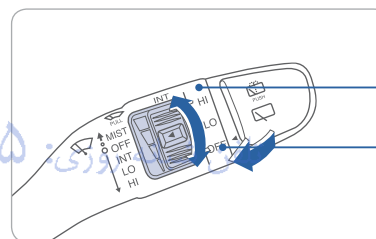

- Fast wiper speed
- Slow wiper speed

Wash with Brief Wipes

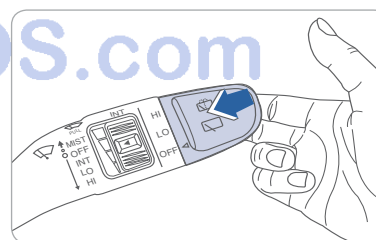

Rear Wiper / Washer Control

- HI** - High wiper speed
- LO** - Low wiper speed
- OFF** - Off
- Push away for rear wash

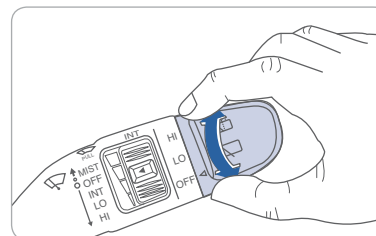

FEATURES AND CONTROLS

PANORAMIC SUNROOF

Sunshade

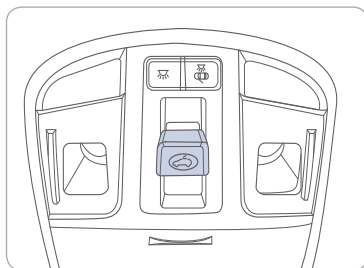

To open the sunshade, pull the sunroof control lever rearward ① to the first detent position.

To close the sunshade when the sunroof glass is closed, push the sunroof control lever forward ②.

Sliding the Sunroof

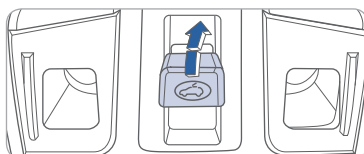
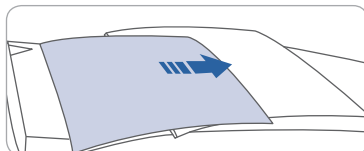

Pull the sunroof control lever backward to the second detent position. First the sunshade will open and then the sunroof will open automatically.

Push the sunroof control lever forward to the first detent position to close the sunroof.

Push the sunroof control lever to the second detent position to close both the sunroof and the sunshade automatically.

Tilting the Sunroof

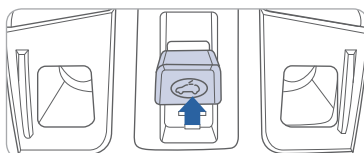
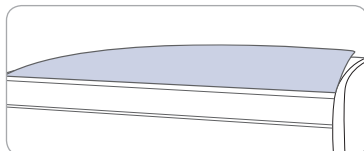

Open

Push the sunroof control lever upward to tilt the sunroof.

Close

Push it upward again to close the sunroof.

You can also push the sunroof control lever forward to close the sunroof.

Push it forward to the second detent position to close the sunroof and the sunshade.

INTERIOR LIGHTS

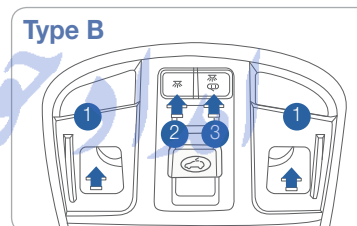
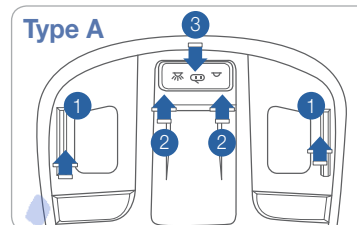

Front Map Lamp ①

Press the switch to turn on / off the map lamp.

Front Room Lamp (☀️) ② (Type A)

Press the switch to turn on / off the room lamp.

Front Room Lamp (☀️) ② (Type B)

Press the switch to turn on / off the room lamp.

Front Door Lamp (☀️) ③ (Type B)

Lights will turn on when any door is opened.

CHILD-PROTECTOR REAR DOOR LOCK

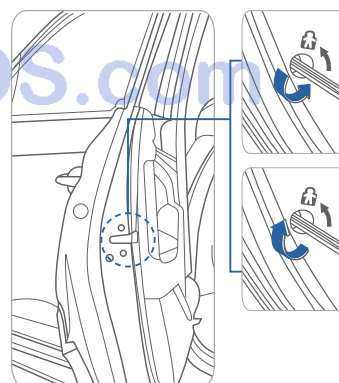

Lock

Insert a screwdriver into the hole and turn it to the lock position.

Unlock

Insert a screwdriver into the hole and turn clockwise to the unlock position.



FEATURES AND CONTROLS



HOMELINK WIRELESS CONTROL SYSTEM

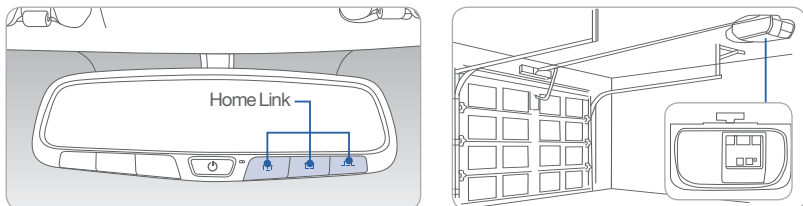

Standard Programming

To train most devices, follow these instructions:

1. For the first-time programming, press and hold the two outside buttons, HomeLink® Channel 1 and Channel 3 buttons until the indicator light begins to flash (after 10 seconds). Release both buttons. Do not hold the buttons for over 20 seconds.
2. Position the end of your hand-held transmitter 1-3in. (2-8 cm) away from the HomeLink® buttons while keeping the indicator light in view.
3. Simultaneously press and hold both the HomeLink® and hand-held transmitter button. DO NOT release the buttons until step 4 has been completed.
4. While continuously holding the buttons, the red indicator Status LED will flash slowly and then rapidly after the HomeLink® successfully trains to the frequency signal from the hand-held transmitter. Release both buttons.

For more detailed information, please refer to your Owner's Manual, or visit www.homelink.com.

SEAT WARMER (front seats)

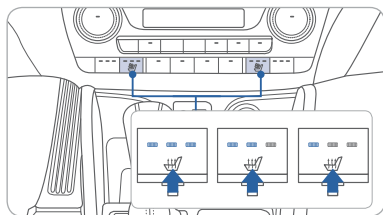

Each time you press the button, the setting is changed as following:

OFF → HIGH → MIDDLE → LOW

AIR VENTILATION SEATS (front seats)

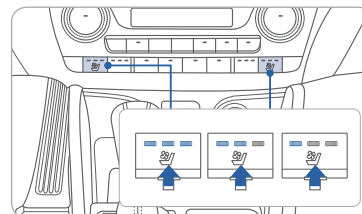

Each time you press the button, the setting is changed as following:

OFF → HIGH → MIDDLE → LOW

REARVIEW CAMERA

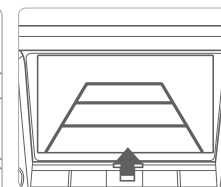
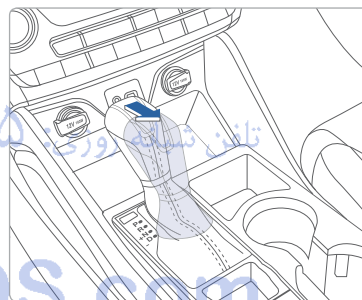

When the transmission is shifted into the R (Reverse), the rearview camera displays the area behind the vehicle.

REAR PARKING ASSIST SYSTEM

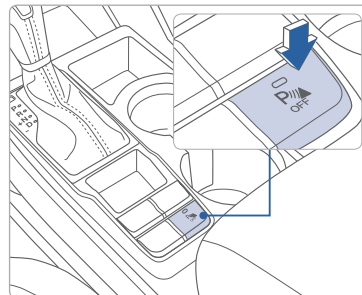

The rear parking assist system assists the driver during the reverse movement of the vehicle by chiming if any object is sensed within a distance of 47 inches behind the vehicle.

Push the button to turn off the rear parking assist system. The indicator light on the button will turn on.

FEATURES AND CONTROLS

INSTRUMENT CLUSTER

Type A

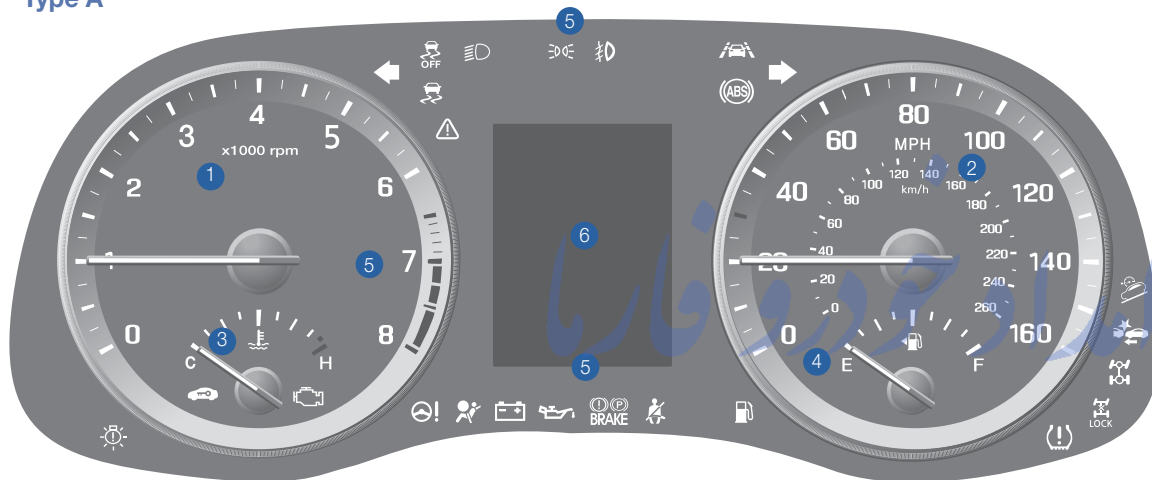

1. Tachometer
2. Speedometer
3. Engine Coolant Temperature Gauge
4. Fuel Gauge
5. Warning and Indicator Lights
6. LCD Display (Including Trip Computer)

Type B

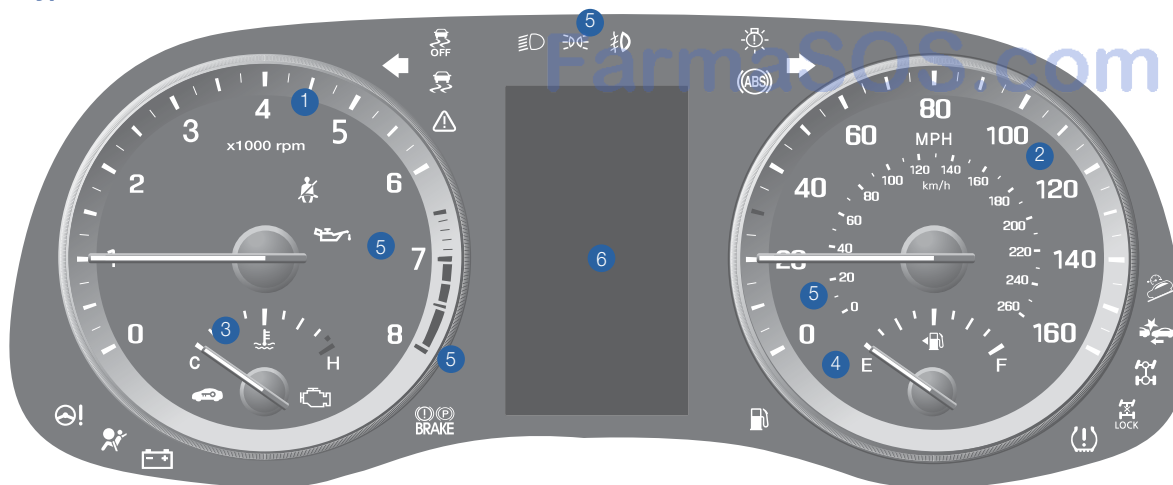



FEATURES AND CONTROLS

LCD DISPLAY MODES

Modes	Symbol	Description
Trip Computer		Displays the most recent driving information including average fuel economy, trip, odometer, average speed, etc.
Turn BY Turn (TBT)		Displays turn-by-turn directions in the LCD cluster when navigation.
LDWS		Displays the state of the Lane Departure Warning System (LDWS).
Audio		Displays the state of the Audio System.
Information	or or	Displays the service interval and warning messages.
User Settings		Changes the settings.

LCD DISPLAY MODES

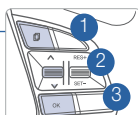
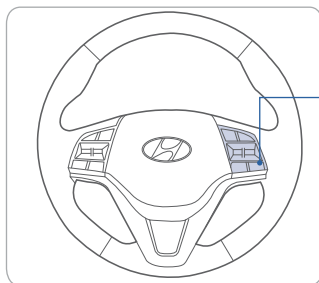

- 1 : MODE button for changing modes
- 2 : MOVE switch for changing items
- 3 : SELECT / RESET button for setting or resetting the selected item



WARNINGS AND INDICATORS

WARNINGS AND INDICATORS		
Air Bag Warning Light	Seat Belt Warning Light	Parking Brake & Brake Fluid Warning Light
ABS Warning Light	Electronic Brake Force Distribution (EBD) System Warning Light	
Electric Power Steering System Warning Light	Malfunction Indicator	Charging System Warning Light
Engine Oil Pressure Warning Light	Low Fuel Level Warning Light	Low Tire Pressure Warning Light
Autonomous Emergency Braking (AEB) Warning Light	All Wheel Drive (AWD) Warning Light	Headlight Warning Light
Master Warning Light	ESC (Electronic Stability Control) Indicator	ESC (Electronic Stability Control) OFF Indicator
Immobilizer Indicator	Turn Signal Indicator	High Beam Indicator
Light ON Indicator	Front Fog Indicator Light	CRUISE Cruise Indicator
Cruise SET Indicator	AUTO HOLD Indicator	SPORT mode Indicator
ECO mode Indicator	Lane Departure Warning System (LDWS) Indicator	All Wheel Drive (AWD) LOCK Indicator Light
Downhill Brake Control (DBC) Indicator Light		

INSTRUMENT PANEL ILLUMINATION

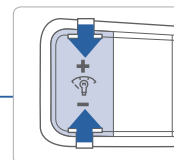
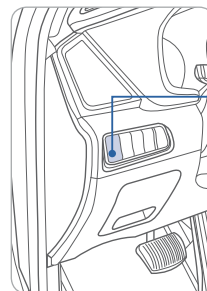

Press + or - to adjust the illumination brightness of the instrument cluster.

FEATURES AND CONTROLS

MANUAL CLIMATE CONTROL

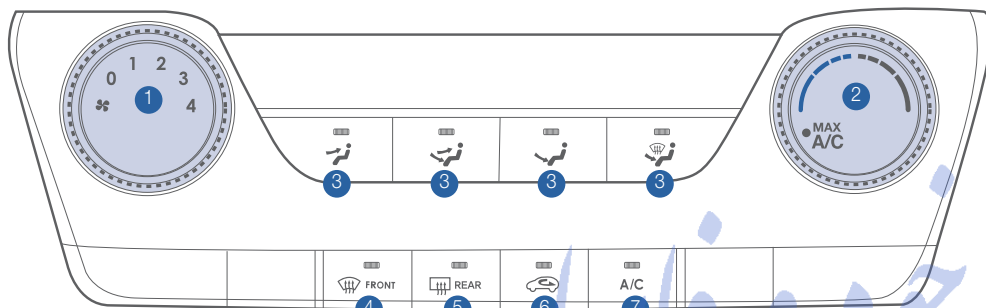

1. Fan Speed Control Knob
2. Temperature Control Knob
3. Mode Selection Buttons
4. Front Windshield Defroster Button
5. Rear Window Defroster Button
6. Air Intake Control Button
7. A / C (Air Conditioning) Button

DEFROSTING / DEFOGGING

1. Press the front windshield defroster control.
2. Set the temperature control to the warmest setting.
3. Set the fan speed to the highest setting.

NOTE:

To reduce the tendency of the glass to fog up and also to improve visibility, keep the surface of the windshield clean by wiping it occasionally with glass cleaner and a clean cloth. In addition, select air intake control to the outside (fresh) air position whenever possible while operating the vehicle.

AIR INTAKE CONTROL

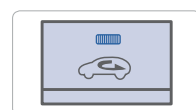
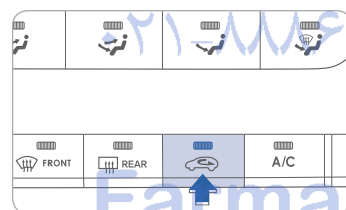

Recirculated air position

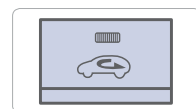

Outside (fresh) air position

MODE SELECTION

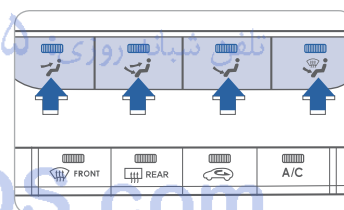

Changes the direction of the air flow as following:

- Face Level
- Bi-Level
- Floor Level
- Floor / Defrost Level

REAR WINDOW DEFROSTER

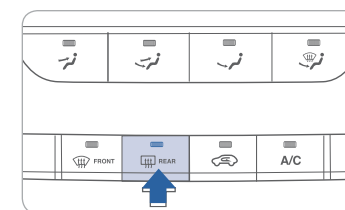

Press to activate/deactivate the rear defroster.



FEATURES AND CONTROLS



AUTOMATIC CLIMATE CONTROL

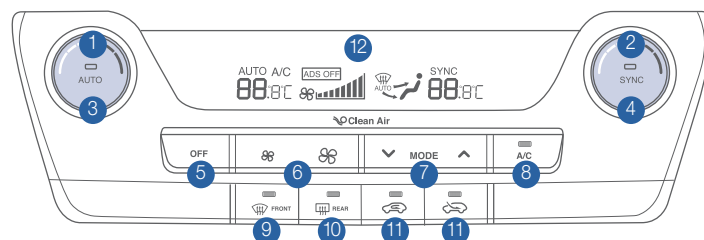

- 1 Driver's Temperature Control Knob
- 2 Passenger's Temperature Control Knob
- 3 AUTO (Automatic Control) Button
- 4 SYNC Button
- 5 OFF Button
- 6 Fan Speed Control Button
- 7 Mode Selection Button
- 8 Air Conditioning Button
- 9 Front Windshield Defroster Button
- 10 Rear Window Defroster Button
- 11 Air Intake Control Button
- 12 Climate Control Information Screen

DEFROSTING / DEFOGGING



1. Press the front windshield defroster control.



2. Set the temperature control to the warmest setting.

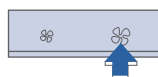

3. Set the fan speed to the highest setting.

SYSTEM OFF MODE

Pressing the OFF button will turn the automatic climate control system off.

- The fan will turn off.
- The outside (fresh) air position will be selected.
- The vented air temperature will be at the last temperature setting.

AIR INTAKE CONTROL

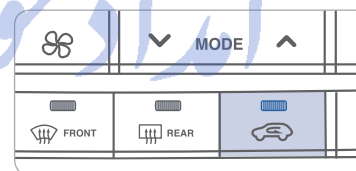

Recirculated air position



Outside (fresh) air position (Type A)



Outside (fresh) air position (Type B)

SYNC BUTTON



Press the SYNC button ON to operate the driver and passenger temperature equally. Press the SYNC button OFF to operate the driver and passenger side temperature individually. The button indicator will turn off.

REAR WINDOW DEFROSTER

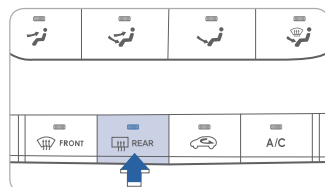

Press to activate/deactivate the rear defroster.

NOTE:

To reduce the tendency of the glass to fog up and also to improve visibility, keep the surface of the windshield clean by wiping it occasionally with glass cleaner and a clean cloth. In addition, select air intake control to the outside (fresh) air position whenever possible while operating the vehicle.

MODE SELECTION



Changes the direction of the air flow as following:



AUTOMATIC HEATING AND COOLING



1. Press the AUTO button.



2. Set the temperature control to the desired setting.

The modes, fan speeds, air intake and air conditioning will be controlled automatically according to the temperature setting.

MULTIMEDIA

STEERING WHEEL AUDIO CONTROL

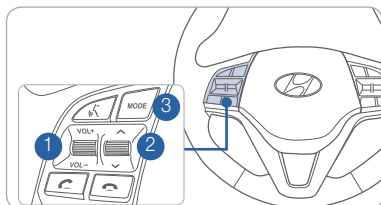

- 1 **VOLUME**
Raises or lowers the speaker volume.
Press to Mute.
- 2 **SEEK / PRESET**
Changes the station.
- 3 **MODE**
Changes the audio source.

BLUETOOTH OPERATIONAL TIPS

In the following situations you or the other party may have difficulty hearing each other:

1. Keep the Bluetooth volume low. High level volume may result in distortion and echo.
2. When driving on a rough road, high speeds and/or with the window open.
3. When the air conditioning vents are facing the microphone and/or when the air conditioning fan is at the max speed.

Steering wheel bluetooth control

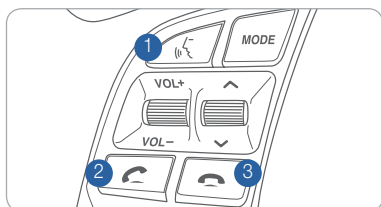

- 1 **TALK**
Activates the voice recognition.
- 2 **CALL**
Places and transfers calls.
- 3 **END**
Ends calls or cancels functions.

To Answer a Call:

- Press the button on the steering wheel.

To Reject a Call:

- Press the button on the steering wheel.

To Adjust Ring Volume:

- Use the VOLUME buttons on the steering wheel.

To Transfer a Call to the handset (private mode):

- Press and hold the button on the steering wheel until the audio system transfers a call to the phone.

To Finish a Call:

- Press the button on the steering wheel.

Making a call using voice recognition:

The menu tree identifies available voice recognition Bluetooth® functions.

Calling by Name:

1. Press the button.
2. Say the following command:
 - “Call <John>”: Connects the call to John.
 - “Call <John> on <on Mobile / in Office / at Home >”: Connects the call to John’s Mobile, Home, or Office phone number.

Dialing by Number:

1. Press the button.
2. Say “Dial Number”.
3. Say the desired phone number.

For the complete list of commands, please refer to your Owner’s Manual.

VOICE RECOGNITION TIPS

Your vehicle is equipped with a Voice Recognition technology which allows drivers to operate their phones without having to take their eyes off of the road to minimize distractions.

Voice recognition performance may be affected if driving with windows and sunroof open; when the heating-cooling system is on; when passing in a tunnel or when driving on rugged and uneven roads.

Quick reference on using voice commands:

To start a voice command, press the button, the following commands are available:

Command	Function
More Help	Provides guidance on commands that can be used anywhere in the system.
Help	Provides guidance on commands that can be used within the current mode.
Calls <Name>	Calls <Name> saved in Contacts. Ex) Call “John”
Dial <Number>	Call can be made by dialing the spoken numbers. Ex) Call “123”
Phone	Provides guidance on Phone related commands. After saying this command, say “Call History”, “Contacts” to execute the corresponding functions.
Call History	Displays the Call History screen.
Contacts (Call by Name)	Displays the Contacts screen. After saying this command, say the name of a contact saved in the Contacts to automatically connect a call.
Dial Number	Displays the Dial number screen. After saying this command, you can say the number which you want to call.



MULTIMEDIA



BLUETOOTH PHONE PAIRING

Pairing tutorials, phone compatibility and operational tips can be found through the Smart QR code by using the QR reader application on your smart phone.

BLUETOOTH PHONE OPERATION

Phone Setup (Pairing Phone) with Audio

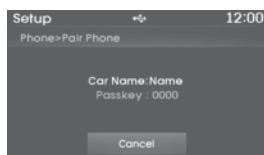
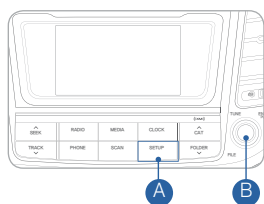

1. Press the SETUP **A** button.
2. Select "Phone" by turning and pressing the TUNE / ENTER **B** knob.
3. Select "Pair Phone" by turning and pressing the TUNE / ENTER **B** knob.
4. Search for the device name as displayed on your mobile phone and connect.
5. Input the passkey displayed on the Audio screen.
6. Pairing is complete.

NOTE : Vehicle must be parked to complete the pairing process.

Phone Setup (Pairing Phone) with Navigation

1. Press the PHONE button in the head unit or  button in the steering wheel remote controller.

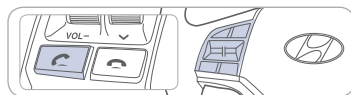
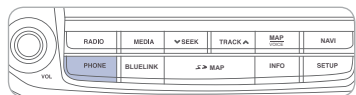

2. Press <YES> to search for Bluetooth phones.
3. Pair your car after your mobile phone detects the Bluetooth device.
4. Enter the passkey or accept the authorization popup. (The default passkey is 0000.)
5. Connect Bluetooth.



NOTE: Vehicle must be parked to complete the pairing process.

BLUE LINK TELEMATICS SYSTEM

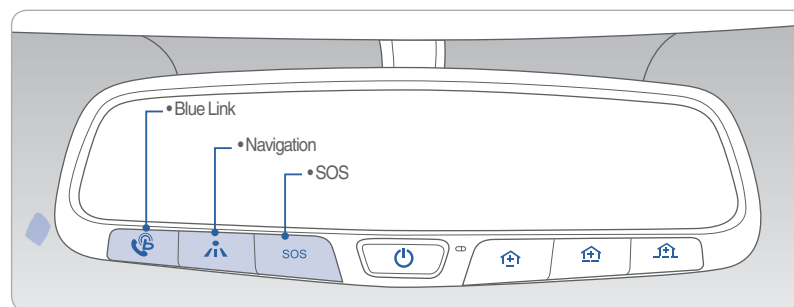

Press the  button for access to the voice-response menu of services.

You can say:

- "Service Link" to schedule a service appointment.
- "Roadside Assistance" for roadside services.
- "Blue Link Account Services" for help with your Blue Link subscription.

- Press the  button for Destination Search Powered by Google®.
- Press the **SOS** button for SOS Emergency Assistance.

- Refer to your Blue Link User's Manual for detailed information on system operation.

- For immediate assistance with subscription services, please call 1-855-2BLUELINK (1-855-225-8354).

Google® is a registered trademark of Google Inc.

Remote Start

Remote Start



You can download the Blue Link mobile app to your compatible smart phone from the following sites:

- iPhone® — Apple® App Store
- Android® — Google Play



Scan to see list of compatible devices and to download the app.

Remote Start enables you to remotely start your vehicle from virtually anywhere. For navigation vehicles, you can also enable climate control remotely and turn on the rear-window defroster, ensuring a warm or cool car is ready to go when you are.

- To use this feature, you must have a Blue Link Personal Identification Number (PIN). To create or change your PIN, log on to www.MyHyundai.com.

Remember:

- Remote Start with Climate Control will automatically shut off after 10 minutes or after selected engine timer runs out in navigation vehicles.
- While this feature is active, the parking lights will blink until vehicle is turned off or when vehicle is in operation.
- To continue operation of the vehicle, the proximity key must be inside the vehicle with the driver prior to pressing the brake and being able to move the gearshift from the P (Park) position.

Preconditions:

- Ignition is OFF
- Alarm is armed (i.e., vehicle locked by key fob Remote Door Lock)
- Gearshift level is in the P (Park) position
- Brake pedal is not depressed
- Engine hood is securely closed
- All the doors are closed and locked
- The tailgate or trunk lid is closed
- The security/panic system is not activated
- The proximity key is not inside the vehicle
- The battery power is not low
- Vehicle is located in an open area
- It has been less than 4 days since last vehicle ignition off
- Vehicle located in area with good cell reception

Remote Start will terminate:

- After 10 minutes or after selected engine timer runs out in navigation vehicles
- Brake is pressed without proximity key inside vehicle
- Alarm is triggered without proximity key inside vehicle
- Door/trunk is opened from inside the vehicle

Notice: Laws in some communities may restrict the use of the features that remotely start the engine. For example, some laws may require a person using the remote start feature to have the vehicle in view when doing so or limit the length of time a vehicle engine may idle. Please check local and state regulations for any requirements and restrictions on remote starting of vehicles and engine idling time.

WARNING!

Do not remote start vehicle in an enclosed environment (i.e., closed garage). Prolonged operation of a motor vehicle in an enclosed environment can cause a harmful build-up of carbon monoxide. Carbon monoxide is harmful to your health. Exposure to high levels of carbon monoxide can cause headaches, dizziness or in extreme cases unconsciousness and/or death. Do not leave children or animals unattended in a vehicle while using the remote start function.

CAUTION!

If the vehicle's windshield wipers are left on when the vehicle was last driven, then the wipers will turn on if the remote start function is activated. To avoid damage to the wiper blades (i.e., due to heavy ice or snow accumulated on the windshield), please always turn the vehicle's windshield wipers off when parking the vehicle.

STANDARD RADIO

Audio mode

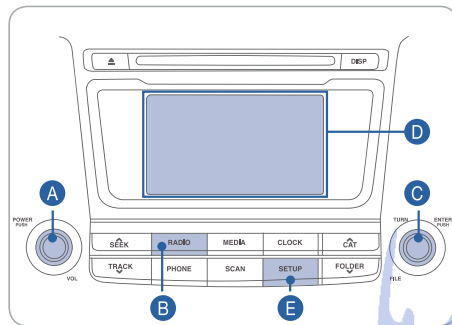

Press **POWER** button **A** to turn radio on.

- TUNING / LISTENING TO CHANNELS
 1. Press **RADIO** button **B**.
 2. Turn the **TUNE** knob **C** to select the desired channel and press the knob.

NOTE :

A clear view of the southern sky helps to ensure XM® radio reception.

- SETTING PRESET MEMORY BUTTONS (FM/AM/XM®)
Press and hold any preset button (1-6) **D** to store current channel.
- ADJUSTING THE SOUND CONTROL
 1. Press the **SETUP** button **E**.
 2. Select "Sound Settings" by turning and pressing the **TUNE** knob **C**.
 3. Select "Bass," "Middle," "Treble," "Fader," or "Balance" by turning and pressing the **TUNE** knob **C**.
 4. Adjust the sound by turning and pressing the **TUNE** knob **C**.

NAVIGATION

Audio mode

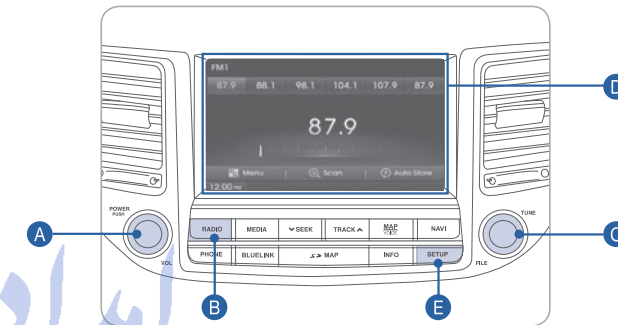

Press **POWER** button **A** to turn radio on.

- TUNING/LISTENING TO CHANNELS
 1. Press **RADIO** button **B**.
 2. Rotate **TUNE** knob **C** to desired channel.

NOTE : تلفن شبانه رو

A clear view of the southern sky helps to ensure XM® radio reception.

- SETTING PRESET MEMORY BUTTONS (FM/AM/XM®)
Press and hold any preset button (1-6) **D** until audible beep is heard to store current channel.
- ADJUSTING THE SOUND CONTROL
 1. Press **SETUP** button **E** and press the sound button on the display.
 2. Touch on-screen arrows to adjust desired setting.



NAVIGATION

Basic features on the map screen

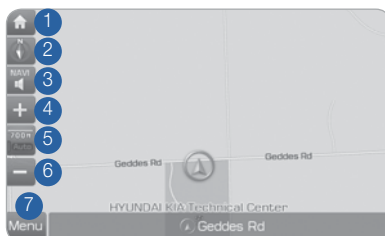

- 1 Move to the Home Screen.
- 2 Change the map view mode.
- 3 Voice Guidance On / Off.
- 4 Zoom in on the map.
- 5 Set the zoom level automatically according to the guidance.
- 6 Zoom out on the map.
- 7 Quick and easy selection of a destination and options.



- 8 Touch to scroll around the map.
- 9 Quick and easy selection of a destination from the map screen.
- 10 Set a waypoint to the current route.
- 11 Save a frequently used address to the address book.
- 12 Find a POI (Point Of Interest) around the current position.
- 13 View the vehicle's current position on the map screen.

Basic features on the map screen

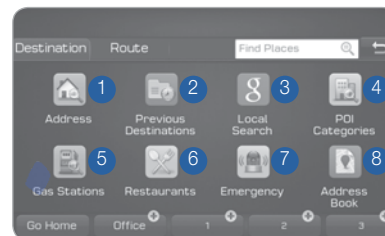

- 1 Set the destination by inputting the address directly.
- 2 Select from the previously input addresses and POIs.
- 3 Search for a location using Google Local Search.
- 4 Select the desired item in POI Categories.
- 5 Search and select the desired item in the Gas Station category.
- 6 Search and select the desired item in the Restaurant category.



- 7 Search and select the desired destination among the searched items.
- 8 Search the destination with the address book.
- 9 Search the destination by phone number.
- 10 Type the freeway name and exit / entrance to search.
- 11 Type the 1st Street name, the State, the 2nd Street name to search.
- 12 Type the coordinates to search.

FarmaSOS.com

AUX, USB AND IPOD PORT

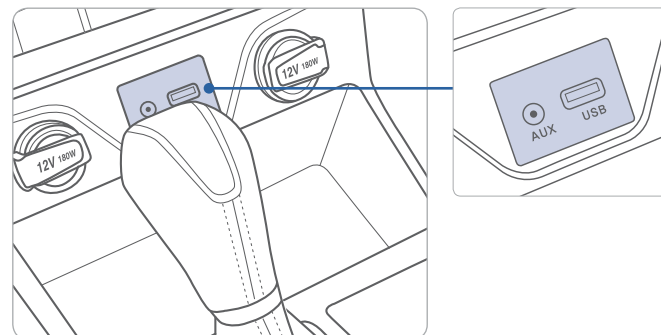

Use the input jack to connect an external audio device and listen to it through the audio system in your vehicle.



DRIVING

ECOSHIFT DUAL CLUTCH TRANSMISSION

NOTE - Ecoshift Dual Clutch Transmission Characteristics

The new technology of the Ecoshift Dual Clutch Transmission is different from traditional automatic or manual transmission:

- The Ecoshift Dual Clutch Transmission is an automatically shifting manual transmission.
- The Ecoshift Dual Clutch Transmission utilizes two clutches connected to a computer-controlled manual gearbox. It provides the convenience of a transmission that shifts automatically with the efficiency of a manual transmission.
- When you turn the engine on and off, you may hear a clicking sound as the system goes through a self test. This is an ordinary sound for the Ecoshift Dual Clutch Transmission.
- If you remove your foot from the brake pedal while you are stopped on a hill, the vehicle will remain stationary for approximately two seconds to prevent the vehicle from rolling backwards. If you depress the accelerator pedal during the two second period, the vehicle will accelerate. If you wait for over two seconds, the vehicle will enter into a creep mode and may roll backwards if the hill is steep.

Caution

- You should always use the foot brake to hold the car on a hill until you are ready to drive. Using the creep mode to hold the car on a hill may damage the clutch.
- If the clutch becomes overheated by excessive use of the clutch to hold on a hill, you may notice shuddering and a blinking display on the instrument cluster. When this occurs, the clutch is disabled until the clutch cools down to normal temperature. If this occurs, pull over to a safe location, shift into P (Park) and apply the foot brake for a few minutes.

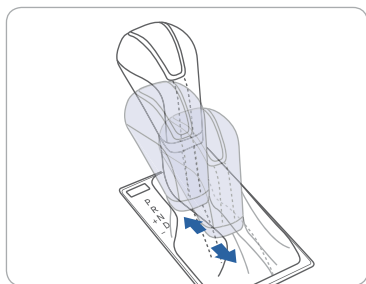

Sport mode

Shift the lever from D into the manual gate to activate the Sport mode. The Sport mode is a recalibrated automatic mode that will hold the gears longer and downshift at a higher RPM for a more dynamic driving style.

AUTOMATIC TRANSMISSION

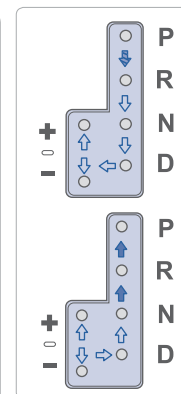
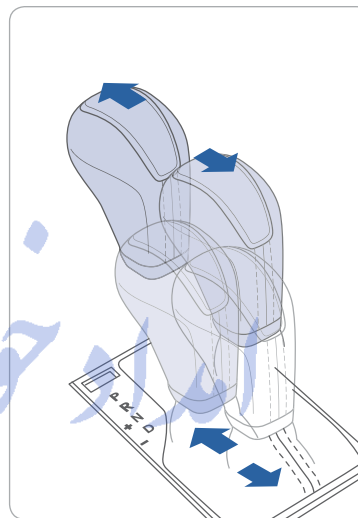

(→) : Press the shift button, then move the shift lever.

(→) : Depress the brake pedal, press the shift button, and then move the shift lever.

(→) : Move the shift lever.

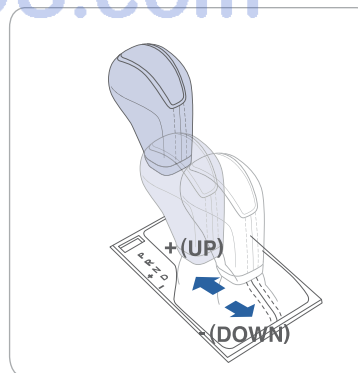

Sport mode

Move the shift lever from D (Drive) into the manual gate to select. Move the shift lever forward (+) to upshift or rearward (-) to downshift.

DRIVING

TIRE PRESSURE MONITORING SYSTEM (TPMS)

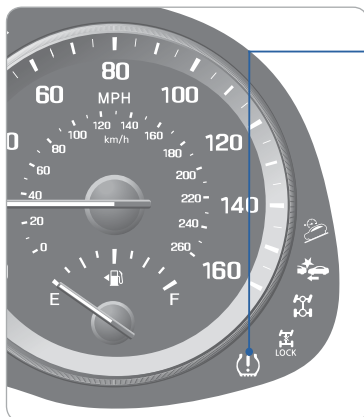

Low Tire Pressure Indicator /
TPMS Malfunction Indicator



Low Tire Pressure Monitor with
Location Indicator
(Shown on the LCD display)

LOW TIRE PRESSURE INDICATOR

Illuminates if one or more of your tires are significantly under-inflated.

TPMS MALFUNCTION INDICATOR

Blinks for approximately one minute, then remains illuminated when there is a malfunction with the TPMS. Inspect all tires and adjust the tire pressure to specification. If the lamp remains illuminated, have the system checked by an authorized Hyundai dealer as soon as possible.

LOW TIRE PRESSURE LOCATION INDICATOR AND TIRE PRESSURE INDICATOR (LCD DISPLAY)

Tire pressures will be displayed after driving a short distance. If a tire pressure drops lower than predetermined specification, the Low Tire Pressure Indicator will illuminate and the LCD display will indicate the tire(s) requiring air.

ELECTRONIC STABILITY CONTROL (ESC)

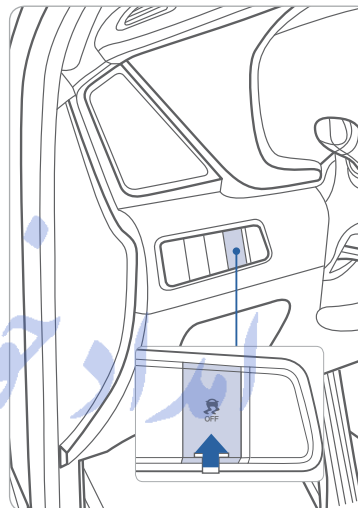

The ESC system is an electronic system designed to help the driver maintain vehicle control under adverse conditions.

The ESC automatically selects the ON position when the engine is started.

- To turn off the Traction Control, press the ESC OFF button shortly.
- To turn off the Traction and the Stability Control, press the ESC OFF button for over 3 seconds.

DOWNHILL BRAKE CONTROL (DBC)

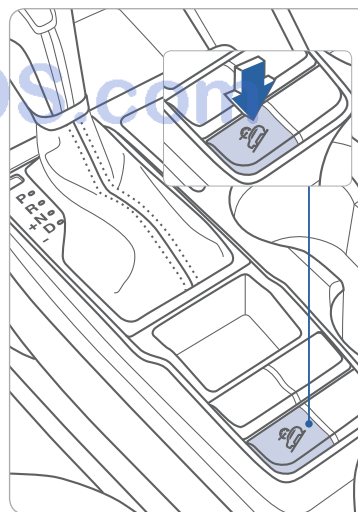

The Downhill Brake Control (DBC) helps the driver maintain a slow speed on a steep downhill without depressing the brake pedal. The system automatically applies the brakes to keep the vehicle speed under 5 mph.

NOTE:

When activated, the speed of the vehicle will be reduced. Please refer to your Owner's Manual for further information.

DRIVING

LANE DEPARTURE WARNING SYSTEM (LDWS)

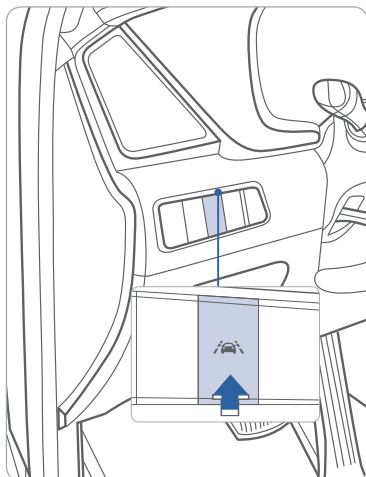

The Lane Departure Warning System detects the lane on the road and warns the driver if the vehicle leaves the lane when the vehicle speed is over 40mph.

- To turn on the LDWS, press the LDWS button.
- To turn off the LDWS, press the LDWS button again.

DRIVE MODE INTEGRATED CONTROL SYSTEM

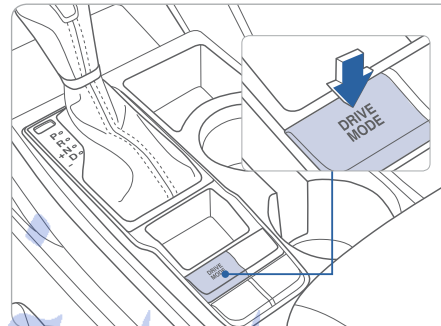

You can select the DRIVE mode according to your preference or the road condition. The system defaults to NORMAL mode each time you start your vehicle. If ECO mode is selected, however, then ECO mode will remain as the default setting.

Each time you press the button, the drive mode changes as follows :

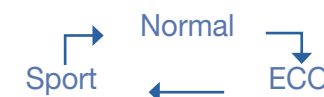

NORMAL mode

NORMAL mode is not displayed on the instrument cluster.

ECO mode

ECO mode helps improve fuel efficiency by controlling certain engine and transmission system operating parameters.

Sport mode

Sport mode focuses on dynamic driving by controlling the steering wheel effort, and engine / transmission performance.

BLIND SPOT DETECTION SYSTEM (BSD)

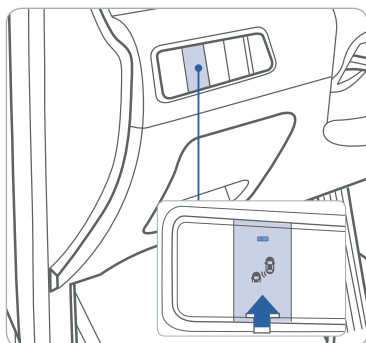

The BSD (Blind Spot Detection) system uses a radar sensor to alert the driver while driving. The system monitors the rear area of the vehicle and provides information to the driver. The system incorporates the following functions:

- 1 Blind Spot Detection (BSD)
 - 2 Lane Change Assist (LCA)
 - 3 Rear Cross Traffic Alert (RCTA) – in reverse gear under 6 mph
- To turn on the BSD, press the BSD button (indicator illuminated).
 - To turn off the BSD, press the BSD button again.

The BSD and LCA systems will activate once the vehicle speed exceeds 20 mph. The RCTA system activates in reverse gear under 6 mph.

AWD LOCK

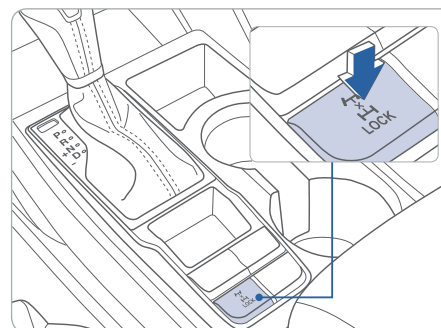

During off-road or inclement weather conditions, press the AWD LOCK switch to drive in full-time AWD. This will divide the power between the front and rear wheels (only when the vehicle speed is under 19 mph). The AWD LOCK indicator light on the instrument cluster will illuminate.

AUTONOMOUS EMERGENCY BRAKING (AEB)

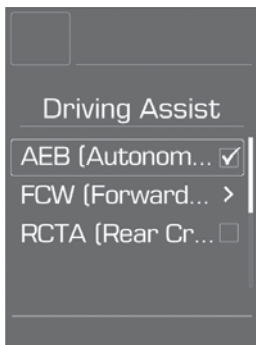

The Autonomous Emergency Braking (AEB) system is designed to detect and monitor the vehicle ahead or detect a pedestrian in the roadway and warn the driver if a collision is imminent.

To operate the system, select the AEB (Autonomous Emergency Braking) in the LCD cluster display under User Settings. Please refer to your Owner's Manual for further information.

امداد خودرو فارما

CRUISE CONTROL

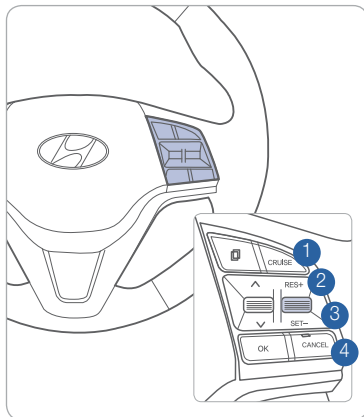

The cruise control system allows you to program the vehicle to maintain a constant speed without holding the accelerator pedal.

- 1 To turn ON / OFF the cruise control.
- 2 To Resume or Increase the cruise control speed.
- 3 To Set or Decrease the cruise control speed.
- 4 To Cancel the cruise control.

تلفن شبانه روزی: ۰۸۵-۸۸۶۲۰۸۱۱

FarmaSOS.com



MEMO



امداد خودرو فارما

تلفن شبانه روزی: ۰۲۱-۸۸۸۶۲۰۸۵

FarmaSOS.com

TUCSON CUSTOMER DELIVERY CHECKLIST

HYUNDAI OWNER	DEALERSHIP NAME
SALES CONSULTANT	DATE
VIN	PREVIOUS VEHICLE

BEFORE DELIVERY

- ☐ CONFIRM "GOOD BATTERY" USING GR8 AND STAPLE TEST TICKET HERE
- ☐ SET TIRE PRESURE LF ____ RF ____ RR ____ LR ____
- ☐ VERIFY VEHICLE IS CLEAN, IN GOOD CONDITION, FREE OF CHIPS AND SCRATCHES · CLEAN WINDSHIELD AND BACK WINDOW
- ☐ ENSURE FLOORMATS ARE SNAPPED INTO PLACE