

## WALK THE CUSTOMER THROUGH EACH OF THE FOLLOWING KEY DELIVERY FEATURES

- MANUAL / AUTOMATIC CLIMATE CONTROL – pages 14-17
  - Explain the different air modes to customer.

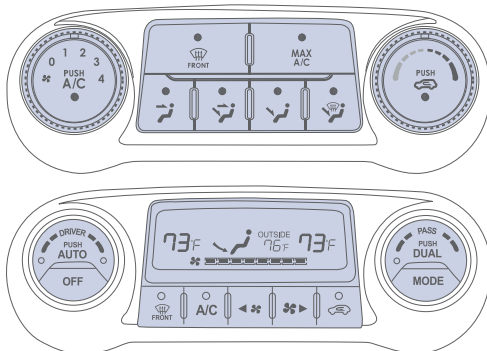

- TIRE PRESSURE MONITORING SYSTEM (TPMS) – page 32
  - Explain TPMS function to customer.
    - When illuminated, one or more tires are under-inflated.
    - Blinks for approximately one minute then remains illuminated when there is a malfunction with the TPMS.



- CLOCK ADJUSTMENT – page 30

- Press and hold the SETUP/CLOCK button ②.
- Rotate knob ① to adjust HOUR. Press knob ① to enter.
- Rotate knob ① to adjust MINUTE. Press knob ① to enter.

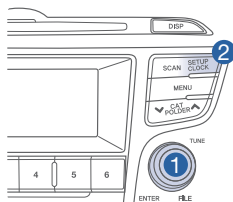

- VEHICLE SETTINGS – page 12-13 & 26-29
  - Demonstrate vehicle settings in instrument cluster
  - Demonstrate navigation use, enter dealer address
  - Show radio presets

- BLUETOOTH – page 20-23
  - Demonstrate phone pairing
    - Refer to [www.hyundaiusa.com/bluetooth](http://www.hyundaiusa.com/bluetooth)
  - Demonstrate QR code



## MAINTENANCE

Scheduled Maintenance	Normal Usage	Severe Usage*
Engine Oil and Filter*	Replace 7,500 or 12 mos.	Replace 3,750 or 6 mos.
Tire Rotation	Perform 7,500	Perform 7,500
Air Cleaner Filter	Inspect 7,500 Replace 30,000	Inspect Same As Normal Replace More Frequently
Vacuum Hose	Inspect 7,500	Inspect Same As Normal
Climate Control Air Filter (for Evaporator and Blower Unit)	Replace 15,000	Replace More Frequently
Air Conditioning Refrigerant	Inspect 15,000	Inspect Same As Normal
Brake Hoses & Lines	Inspect 15,000	Inspect Same As Normal
Drive Shafts & Boots	Inspect 15,000	Inspect 7,500
Exhaust Pipe & Muffler	Inspect 15,000	Inspect Same As Normal
Front Disc Brake/Pads, Calipers & Rotors	Inspect 15,000	Inspect More Frequently
Propeller Shaft (AWD)	Inspect 15,000	Inspect 7,500
Steering Gear Box, Linkage & Boots/ Lower Arm Ball Joint, Upper Arm Ball Joint	Inspect 15,000	Inspect More Frequently
Suspension Mounting Bolts	Inspect 15,000	Inspect Same As Normal
Brake Fluid	Inspect 30,000	Inspect Same As Normal
Fuel Filter	Inspect 30,000	Inspect Same As Normal
Fuel Lines, Fuel Hoses and Connections	Inspect 30,000	Inspect Same As Normal
Fuel Tank Air Filter	Inspect 30,000	Inspect Same As Normal
Rear Disc Brake/Pads, Parking Brake	Inspect 30,000	Inspect More Frequently
Vapor Hose, Fuel Tank & Fuel Filler Cap	Inspect 30,000	Inspect Same As Normal
Rear Axle Oil (AWD)	Inspect 37,500	Replace 75,000
Transfer Case Oil (AWD)	Inspect 37,500	Replace 75,000
Valve Clearance	Inspect 60,000	Inspect Same As Normal
Drive Belt (Alt, A/C)	1st Inspect 60,000 or 72 mos. Add. Inspect 15,000 or 24 mos.	Inspect Same As Normal
Spark Plugs (Iridium Coated)	Replace 105,000	Replace More Frequently
Coolant	1st Replace 120,000 or 120 mos. Add. Replace 30,000 or 24 mos.	Replace Same As Normal
Automatic Transaxle Fluid	No check, No service required	Replace 60,000

\*Check the engine oil regularly between recommended oil change. Hyundai recommends Quaker State oil.

\*See Owner's Manual for details.

Looking for more detailed information? This Quick Reference Guide does not replace your vehicle's Owner's Manual. If you require additional information or are unsure of a specific issue, you should always refer to the vehicle's Owner's Manual or contact your authorized Hyundai dealer.

The information contained in this Quick Reference Guide was correct at the time of printing; however, specifications and equipment can change without notice. No warranty or guarantee is being extended in this Quick Reference Guide, and Hyundai reserves the right to change product specifications and equipment at any time without incurring obligations. Some vehicles are shown with optional equipment. Specifications apply to U.S. vehicles only. Please contact your Hyundai dealer for current vehicle specifications.

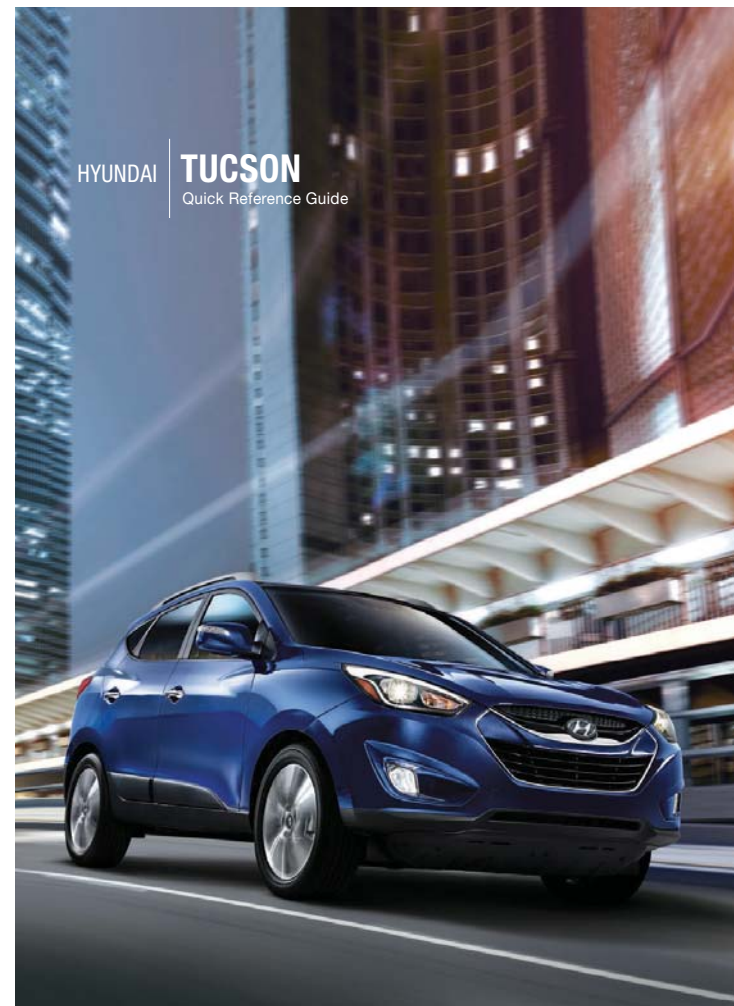

HYUNDAI **TUCSON**  
Quick Reference Guide

[www.hyundai.com](http://www.hyundai.com)

**HYUNDAI**  
NEW THINKING.  
NEW POSSIBILITIES.

Roadside Assistance: 1-800-243-7766  
Consumer Affairs: 1-800-633-5151  
XM® Radio: 1-800-967-2346  
Blue Link: 1-855-2BLUELINK (1-855-225-8354)

NP150-T2014  
(Rev 10/13/14)  
Printing 10/16/14

# Table of contents

## GETTING STARTED

Driver's main controls	07
Engine start/stop button	03
Front seat adjustment	04
Headrest adjustment	05
Rear seat folding	05
Remote keyless entry	02
Seat belt adjustment	05
Tailgate opening	03

## FEATURES AND CONTROLS

Central door lock switch	07
Climate control	14-17
Defrosting - defogging	14-17
Engine start/stop button	03
Fuel Filler Door	06
Head lights and fog lights	08
Homelink wireless control	11
Instrument cluster	12-13
Instrument panel illumination	13
Interior lights	11
Panorama Sunroof	10
Steering wheel adjustment	06
Steering wheel functions	18-19
Trip computer	13
Wiper and washer	09

## MULTIMEDIA

Audio	26-27
Blue Link telematic system	24-25
Bluetooth operation tips	20-21
Bluetooth phone pairing	22-23
Navigation	27-29
Standard radio	26
Steering wheel functions	18-19

## DRIVING

AWD lock	34
Clock adjustment	30
Downhill Brake Control (DBC)	34
ECO system	33
Electronic Stability Control (ESC)	32
Rear view camera	35
Tire pressure monitoring system (TPMS)	32
Transmission	31

\* Some vehicles may not be equipped with all the listed features.

## Frequently Asked Questions

- Pair phone to your vehicle. Refer to page 22 and 23.
- Garage door opener set up. Refer to page 11.



Head lights  
and fog  
lights  
Page08

Steering  
wheel audio  
control  
Page19

Instrument  
cluster  
Page12-13

Trip  
computer  
Page13

Cruise  
control  
system  
Page18



Wiper and washer  
Page09

Audio  
Page26-27

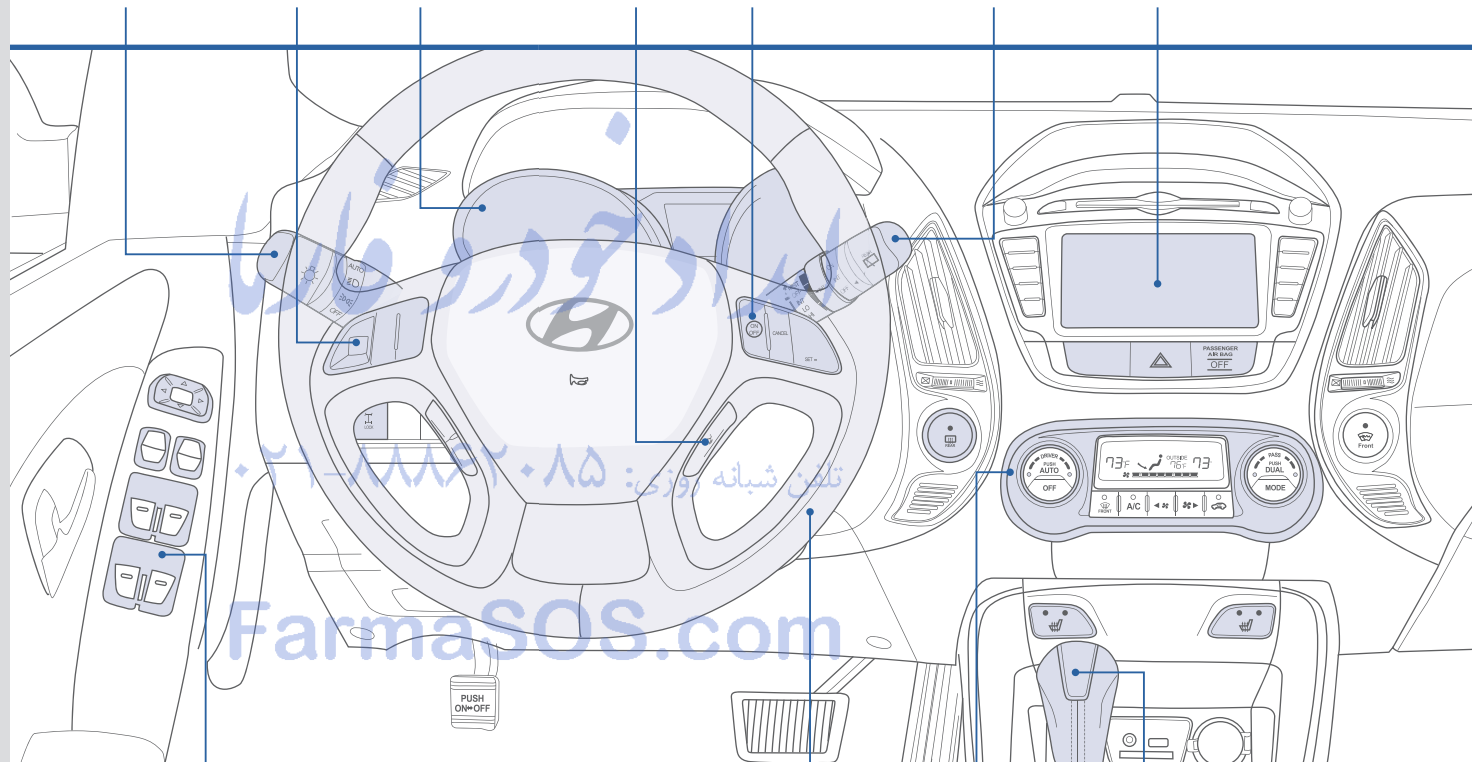

Driver's Main  
Controls  
Page07

Steering  
wheel  
adjustments  
Page06

Climate  
control  
Page14-17

Automatic  
transmission  
Page31



Use this Quick Reference Guide to learn about the features that will enhance your enjoyment of your Hyundai. More detailed information about these features are available in your Owner's Manual.

## WARNING!

To reduce the risk of serious injury to yourself and others, read and understand the important SAFETY INFORMATION in your Owner's Manual.

## REMOTE KEYLESS ENTRY

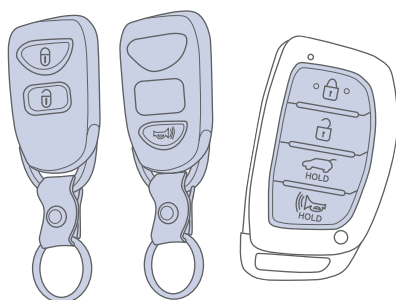

- Lock
- Unlock
- Tailgate unlock
- Panic



## TAILGATE OPENING

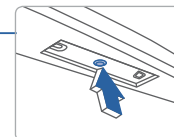
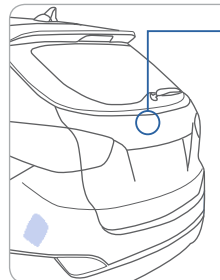

Press to open.  
Smart key  
needs to be  
within range.

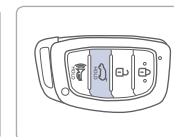

Press and hold  
to unlock.

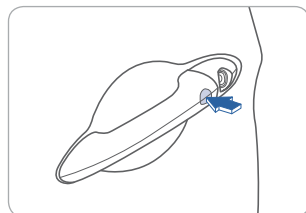

### Driver's door Lock / Unlock

Smart key must be within 28~40 in. from the outside door handle.

#### Unlocking doors:

1. Carry the Smart Key.
2. Press the door handle button.
3. Press the door handle button again
4. seconds to unlock all doors.

#### Locking doors:

1. Press the door handle button.

## ENGINE START/STOP BUTTON

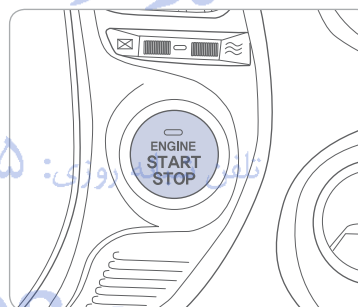

With the ignition OFF, press the engine start/stop button:

- Once for ACC (Accessory) mode.
- Twice for ON mode.
- Three times for OFF.

To start the engine, press the start/stop button while depressing the brake pedal. To shut engine OFF, shift to P (Park) and press the start/stop button.

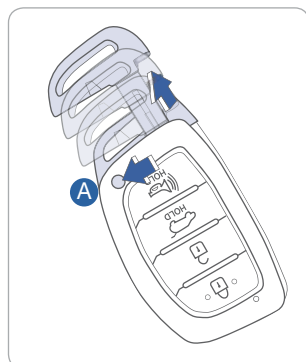

### Remove mechanical key

Press and hold the release **A** button and remove the key.

### Reinstall mechanical key

Put the key into the hole and push it until a click sound is heard.

## Emergency situations

### Shut off engine while driving:

- Press engine start/stop button for more than 2 seconds or press it 3 times consecutively within 3 seconds.

### Restart engine while driving

- Press engine start/stop button with shift lever in N (Neutral).

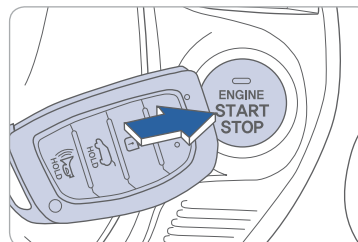

If the smart key battery is weak or the smart key does not work correctly, press the Engine Start/Stop button with the smart key in the direction of the picture.

## FRONT SEAT ADJUSTMENT (Manual)

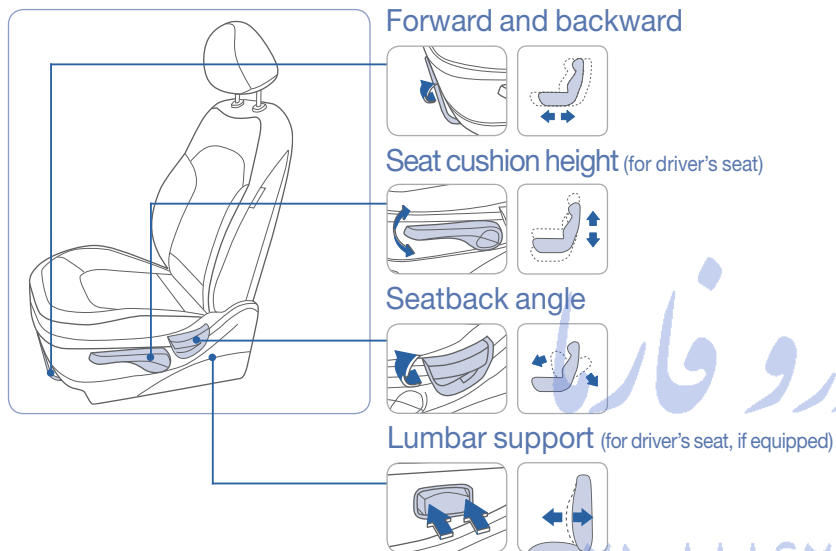

## FRONT SEAT ADJUSTMENT (Power)

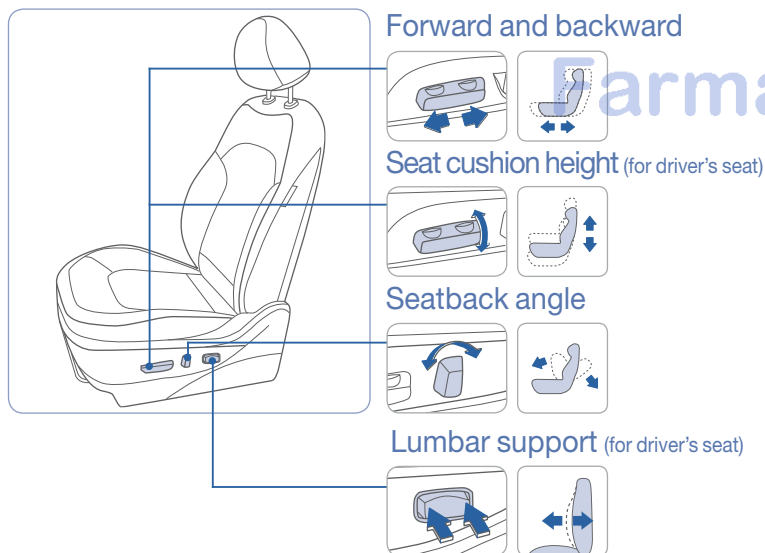

## REAR SEAT FOLDING

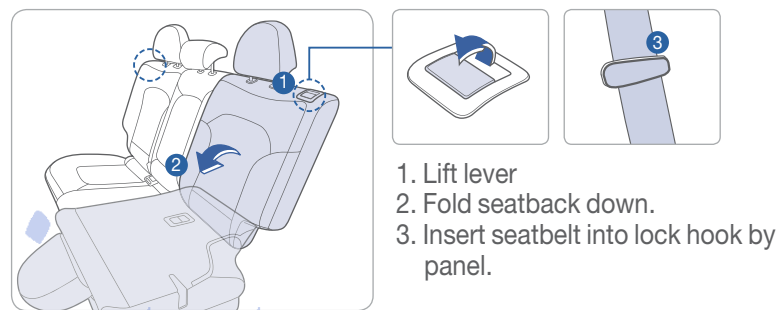

## HEADREST ADJUSTMENT

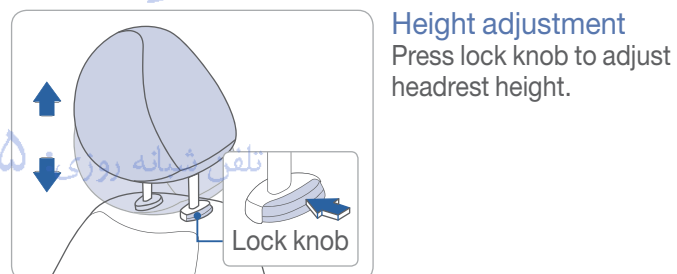

## SEAT BELT ADJUSTMENT (Front seat)

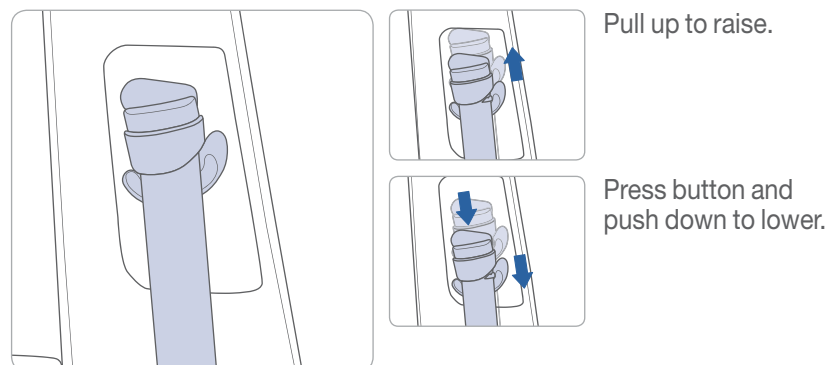



## STEERING WHEEL ADJUSTMENTS

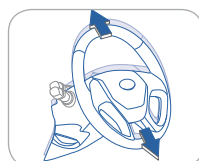
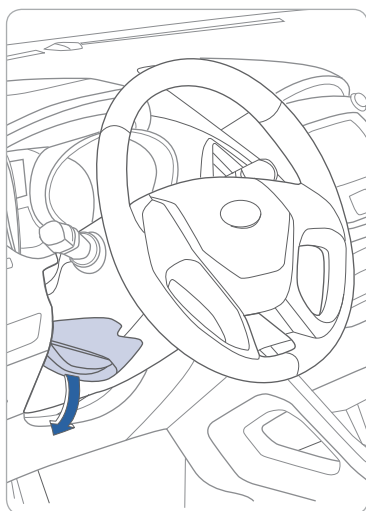

Tilt

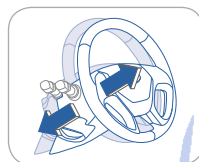

Telescopic

**NOTE:** Do not adjust while driving.  
1. Pull the lever down.  
2. Set the tilt angle and/or telescopic distance.  
3. Pull the lever up.

## DRIVER'S MAIN CONTROLS

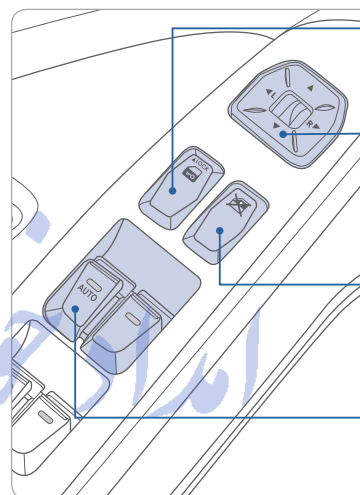

Door Lock

Locks/unlocks all doors.

Outside Rearview Mirrors

Press L (left) or R (right) on the switch. Adjust the mirror by using the directional switch.

Power Window Lock Switch

Disables the power window switches on the passenger doors.

Window Auto down/up (driver's side only)

Press past detent to fully open/close window.

## FUEL FILLER DOOR

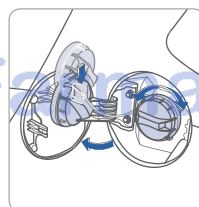
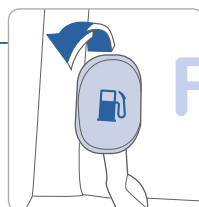
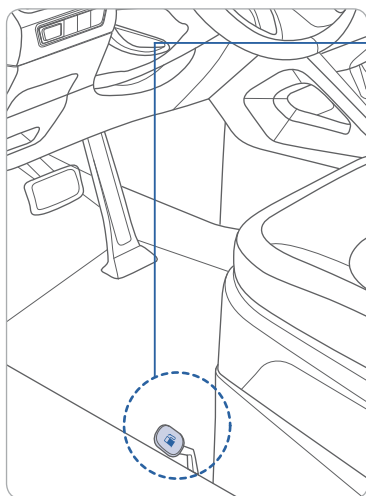

Open : Turn it counterclockwise.  
Lock : Turn it clockwise.

### NOTE

Tighten fully until a click is heard. The Check Engine Light (⚠️) may illuminate if the cap is not tighten properly.

Check the engine oil regularly between recommended oil changes.

## CENTRAL DOOR LOCK SWITCH

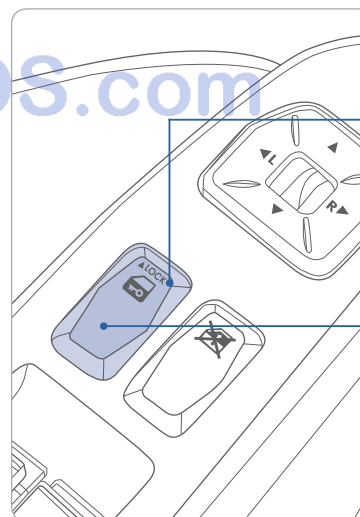

All doors will lock.

All doors will unlock.

## HEADLIGHTS AND FOG LIGHTS

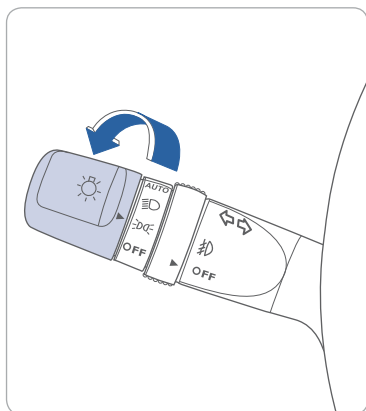

- ▶ | **OFF** OFF position
- ▶ | Parking light position
- ▶ | Headlight position
- ▶ | **AUTO** Auto light position

### Escort Function (if equipped)

Head lights may stay on for 15 seconds after exiting and locking vehicle.  
Press remote lock button twice to turn headlights off.  
See Owner's Manual for more detail.

### Turn signals and lane change signals

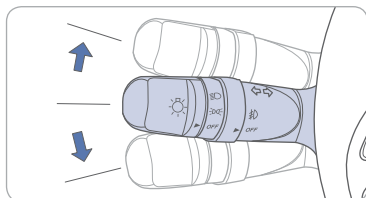

### High beams

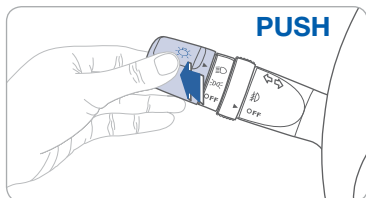

### Flashing headlights

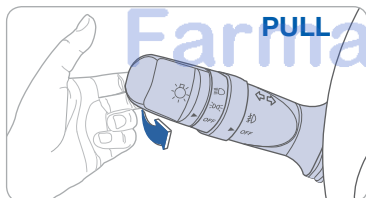

### Fog lights (if equipped)

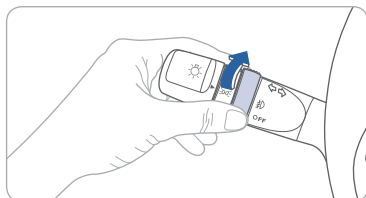

## WIPER AND WASHER

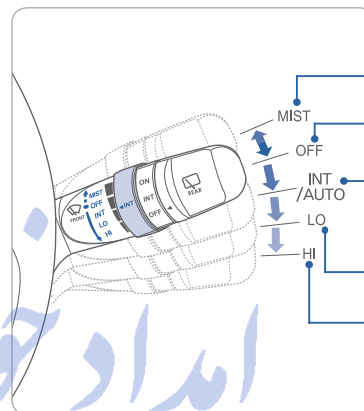

- MIST - Single wipe
- OFF - Off
- INT - Intermittent wipe
- AUTO - Auto control wipe
- LO - Normal wiper speed
- HI - Fast wiper speed

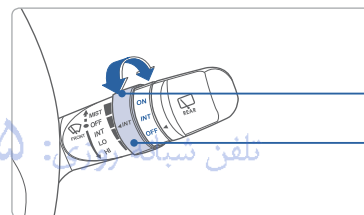

### Intermittent wipe time adjustment (if equipped)

- Faster intervals between wipes
- Slower intervals between wipes

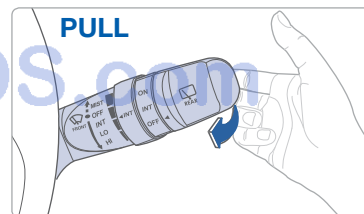

### Wash with brief wipes

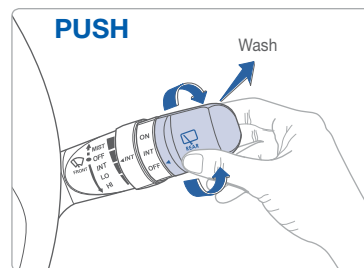

### Rear wiper/washer control

- ON - Normal wiper operation
- INT - Intermittent wiper operation
- OFF - Wiper is not in operation

- Push away for rear wash



## PANORAMA SUNROOF

### Sliding the sunroof

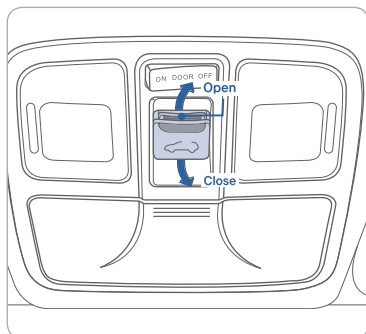

#### Open

Press switch rearward.  
Press switch rearward past the detent to open completely.

#### Close

Press switch forward.  
Press switch forward past the detent to close completely.

#### NOTE

Do not leave the roller blind closed while the sunroof is open.

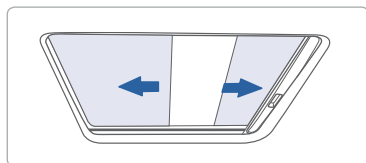

### Tilting the sunroof

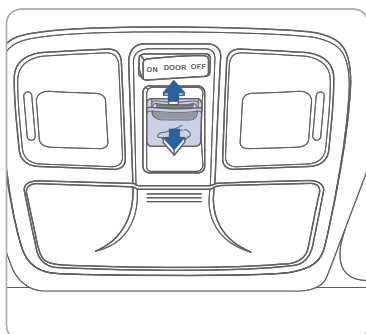

#### Tilt

Push or pull switch up or down.

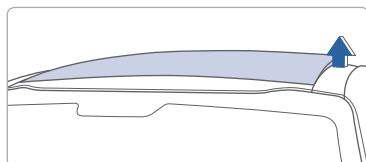

## INTERIOR LIGHTS

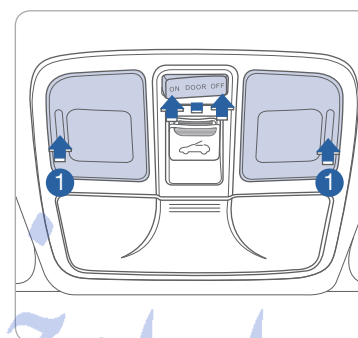

Press the lens ① to turn the map lamp on or off.

#### ON

Light will turn on.

#### DOOR

Light will turn on when the front or rear doors are opened.

#### OFF

The lights stay off at all times.

## HOMELINK WIRELESS CONTROL SYSTEM

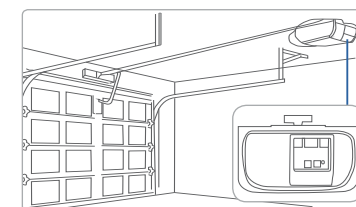
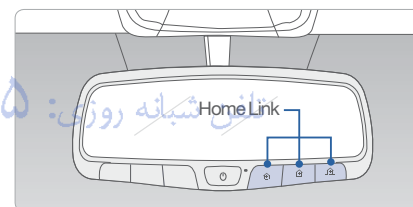

### Standard Programming

To train most devices, follow these instructions:

1. For first-time programming, press and hold the two outside buttons, HomeLink® Channel 1 and Channel 3 Buttons, until the indicator light begins to flash (after 20 seconds). Release both buttons. Do not hold the buttons for longer than 30 seconds.
2. Position the end of your hand-held transmitter 1-3 inches (2-8 cm) away from the HomeLink® buttons while keeping the indicator light in view.
3. Simultaneously press and hold both the HomeLink® and hand-held transmitter button. DO NOT release the buttons until step 4 has been completed.
4. While continuing to hold the buttons the red indicator Status LED will flash slowly and then rapidly after HomeLink® successfully trains to the frequency signal from the hand-held transmitter. Release both buttons.

For more detailed information, refer to your Owner's Manual or visit [www.homelink.com](http://www.homelink.com).

## FEATURES AND CONTROLS

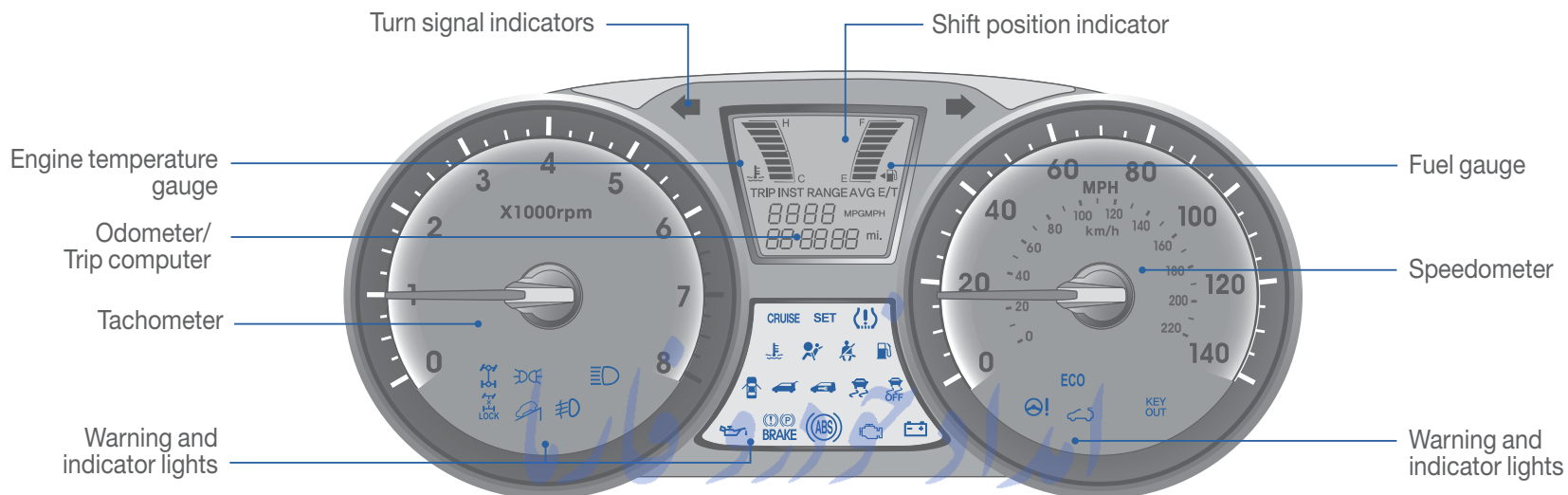

### WARNINGS AND INDICATORS

Air bag warning light	Parking brake & Brake fluid warning light	ABS warning light
Seat belt warning light	Low tire pressure indicator / TPMS (Tire Pressure Monitoring System) malfunction indicator	
High beam indicator	Engine oil pressure warning light	Charging system warning light
Electric Power Steering system warning light	Door ajar warning light	Turn signal indicator
Tailgate open warning light	Shift pattern indicator	ESC (Electronic Stability Control) indicator
DBC indicator	Low fuel level warning light	Malfunction indicator
ESC (Electronic Stability Control) OFF indicator	CRUISE Cruise indicator	AWD system warning light
SET Cruise SET indicator	AWD LOCK indicator	ECO ECO indicator
Front fog light indicator	Light on indicator	KEY OUT Key out indicator
Engine coolant temperature warning light	Sunroof open warning light	

### INSTRUMENT PANEL ILLUMINATION

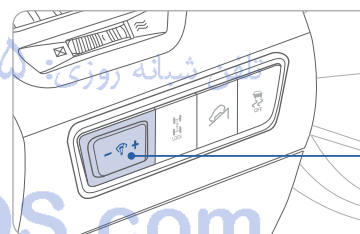

Press - or + to adjust instrument cluster illumination brightness.

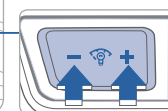

### TRIP COMPUTER

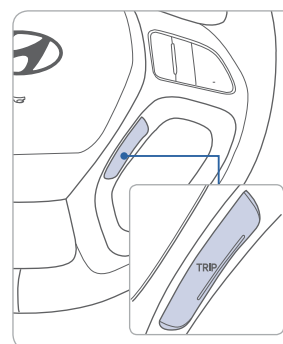

Press the TRIP button for less than 1 second to select function as follows:

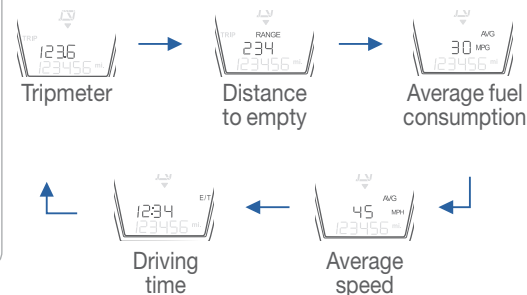



## FEATURES AND CONTROLS

### Manual Climate Control

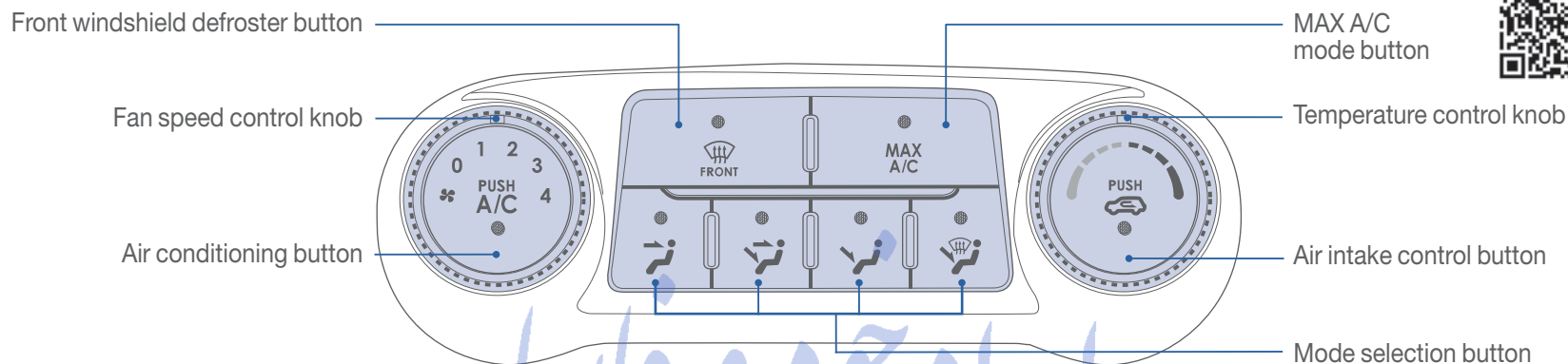

### DEFROSTING / DEFOGGING

1. Press the front windshield defrost control.
2. Set the temperature control to the warmest setting.
3. Set the fan speed to the highest setting.

#### NOTE

To reduce tendency of the glass fogging and also improve visibility, keep the interior surface of the windshield clean by wiping it with a clean cloth and glass cleaner.

### AIR INTAKE CONTROL

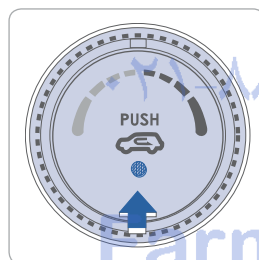

Recirculated air position



Outside (fresh) air position

### MODE SELECTION

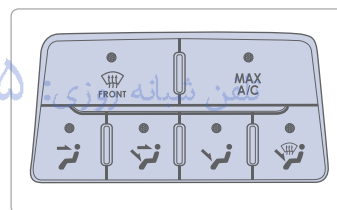

Changing the direction of the air flow as follows.

MAX A/C Level

Face Level

Bi-Level

Floor Level

Floor/Defrost Level

Defrost Level

### REAR WINDOW DEFROSTER

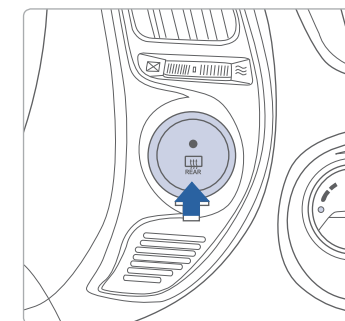

Press to activate/deactivate the rear defroster.

## FEATURES AND CONTROLS

### Automatic Climate Control

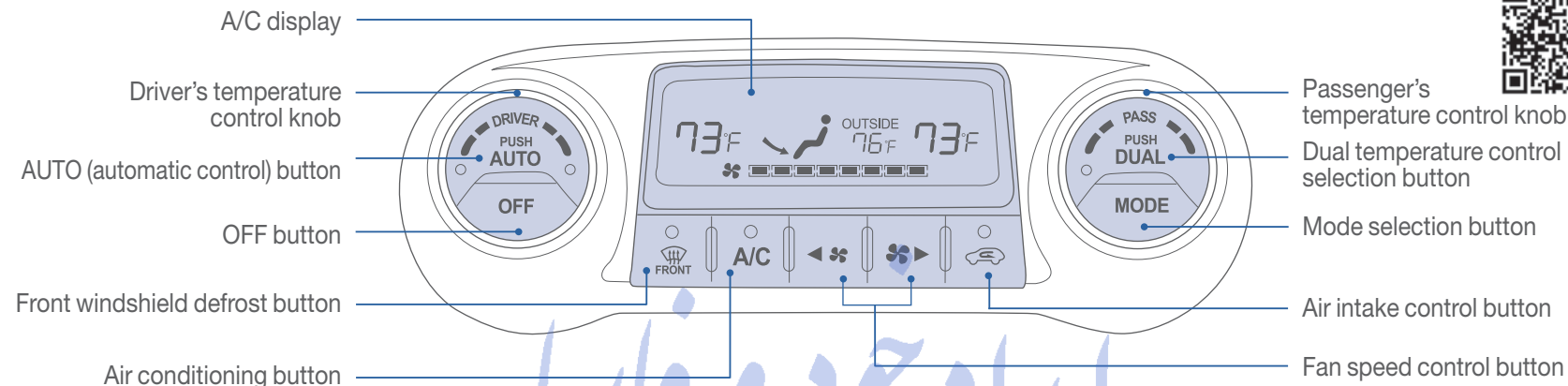

### DEFROSTING / DEFOGGING

1. Press the front windshield defrost control.
2. Set the temperature control to the warmest setting.
3. Set the fan speed to the highest setting.

### SYSTEM OFF MODE

Pressing the OFF button will place the system in the off mode.

- Front blower will turn off.
- Outside (fresh) air position is selected.
- Vented air will be at last set temperature.

### AIR INTAKE CONTROL

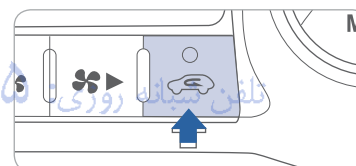

- Recirculated air position
- Outside (fresh) air position

### DUAL BUTTON

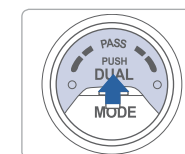

Press the DUAL button to operate the driver's and passenger's side temperature individually.

### REAR WINDOW DEFROSTER

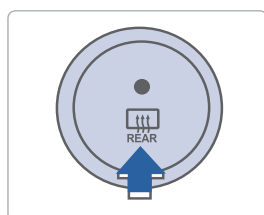

Press to activate/deactivate the rear defroster.

### NOTE

To reduce tendency of the glass fogging and also improve visibility, keep the interior surface of the windshield clean by wiping it with a clean cloth and glass cleaner.

### MODE SELECTION

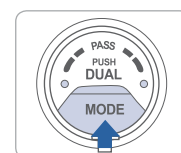

Changing the direction of the air flow as follows.



### AUTOMATIC HEATING AND COOLING



1. Press the AUTO button.
2. Set the temperature control to the desired setting.

The modes, fan speeds, air intake and air-conditioning will be controlled automatically according to the temperature setting.

## STEERING WHEEL FUNCTIONS

### Cruise control

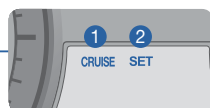
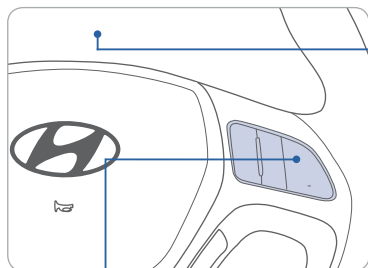

- 1 Cruise indicator
- 2 Cruise set indicator

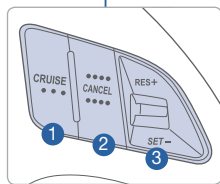

#### To set a cruising speed

1. Press 1 and the CRUISE indicator will illuminate in the instrument cluster. Accelerate to desired cruising speed (above 25 mph).
2. Toggle switch 3 down and remove your foot from the accelerator pedal.

#### To accelerate or decelerate

- Toggle switch 3 up to increase set cruising speed.  
Toggle switch 3 down to decrease set cruising speed.

#### To cancel cruising speed

- Press 2 or press brake pedal, or press ON/OFF 1 button.

#### To resume previously set speed

- Toggle switch 3 up.

### Audio control

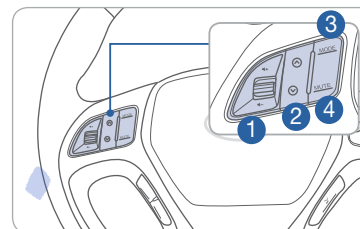

- 1 **VOLUME**  
Raises or lowers speaker volume.
- 2 **SEEK/PRESET**  
Change station.
- 3 **MODE**  
Change the audio source.
- 4 **TALK**  
Activate voice recognition.

Please refer to your Owner's Manual for more detailed information on how to use your audio system. Complimentary XM® subscription ends three months following the vehicle date of sale. Please contact XM® Radio at 1-800-XM-RADIO (1-800-967-2346) to renew your XM® subscription.

### Bluetooth Control

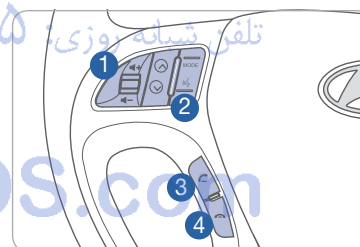

- 1 **VOLUME**  
Raises or lowers speaker volume.
- 2 **TALK**  
Activates voice recognition.
- 3 **CALL**  
Places and transfers calls.
- 4 **END**  
Ends calls or cancels functions.

To redial previously dialed number, press and hold 3.

\* Bluetooth is a wireless technology that allows multiple devices to be connected in a short range, low powered devices like hands-free, stereo headset, wireless remocom, etc. For more information, visit the website at [www.bluetooth.com](http://www.bluetooth.com)

## BLUETOOTH OPERATIONAL TIPS

In the following situations you or the other party may have difficulty hearing each other:

1. Keep the Bluetooth volume to a low level. High level volume may result in distortion and echo.
2. When driving on a rough road, high speeds and/or with the window open.
3. When the air conditioning vents are facing the microphone and/or when the air conditioning fan is at the max speed.

### Steering wheel bluetooth control

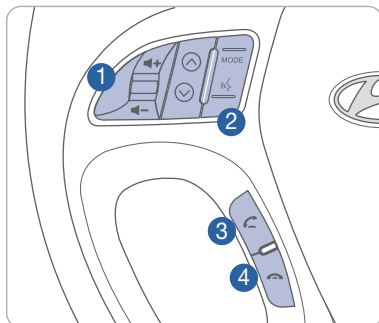

- 1 **VOLUME**  
Raises or lowers speaker volume.
- 2 **TALK**  
Activates voice recognition.
- 3 **CALL**  
Places and transfers calls.
- 4 **END**  
Ends calls or cancels functions.

To redial previously dialed number, press and hold 3

#### To Answer a Call:

- Press button on the steering wheel.

#### To Reject a Call:

- Press button on the steering wheel.

#### To Adjust Ring Volume:

- Use the VOLUME buttons on the steering wheel.

#### To Transfer a Call to the Phone

##### (Secret Call):

- Press and hold button on the steering wheel until the audio system transfers a call to the phone.

#### To Finish a Call:

- Press button on the steering wheel.

### Making a call using voice recognition:

The menu tree identifies available voice recognition Bluetooth® functions.

#### Calling by Name:

1. Press button.
2. Say the following command:
  - “Call <John Smith>”: Connects the call to John.
  - “Call <John Smith> on <Mobile/Home/Office>”: Connects the call to John’s Mobile, Home, or Office phone number.

#### Dialing by Number:

1. Press button.
2. Say “Dial”.
3. Say desired phone numbers when prompted.
5. Say “Dial” to complete the number and make a call.

For complete list of commands, refer to your Owner’s Manual.

## VOICE RECOGNITION TIPS

Your vehicle is equipped with Voice Recognition technology which allows drivers to operate their phones without having to take their eyes off the road to minimize distractions.

Voice recognition performance may be affected if driving with windows and sun roof open; when the heating-cooling system is on; when passing in a tunnel or when driving on rugged and uneven roads.

Quick reference on using voice commands

To start voice command. Press the key, the following commands are available:

Command	Function
More Help	Provides guidance on commands that can be used anywhere in the system
Help	Provides guidance on commands that can be used within the current mode.
Calls <Name>	Calls <Name> saved in Contacts. Ex) Call “John”
Dial <Number>	Call can be made by dialing the spoken numbers. Ex) Call “123”
Phone	Provides guidance on Phone related commands. After saying this command, say “Call History”, “Contacts” to execute corresponding functions.
Call History	Displays the Call History screen.
Contacts (Call by Name)	Displays the Contacts screen. After saying this command, say the name of a contact saved in the Contacts to automatically connect the cell.
Dial Number	Display the Dial number screen. After saying this command, you can say the number what you want to call.



## BLUETOOTH PHONE PAIRING

Pairing tutorials, phone compatibility and Operational tips can be found through the Smart QR code using the QR reader application on your Smartphone.



### Phone setup (pairing phone) with Audio

#### Type A

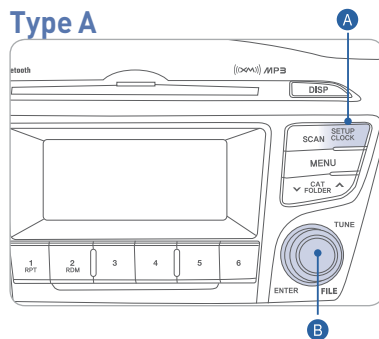

#### Type B

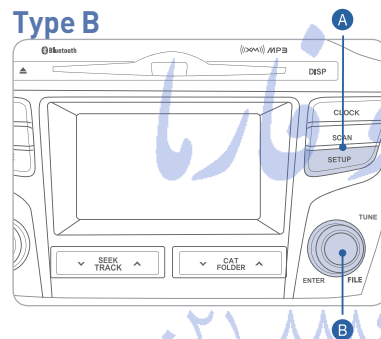

1. Press the SETUP **A** button.
2. Select "Phone" by turning and pressing the TUNE/ENTER **B** knob.
3. Select "Pair Phone" by turning and pressing the TUNE/ENTER **B** knob.
4. Search for the device name as displayed on your mobile phone and connect.
5. Input the passkey displayed on the Audio screen.

#### Type A

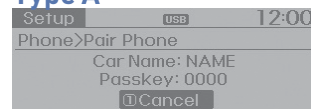

#### Type B

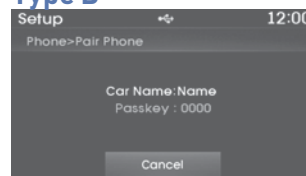

6. Pairing completion is displayed.

#### NOTE

Vehicle must be park to complete pairing process.

### Phone Setup (Pairing phone) with Navigation

1. Press the call button on the steering wheel remote controller.

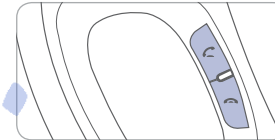

2. Press Yes button on the screen.

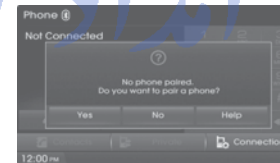

3. Search for the car name and pair the device.

#### NOTE

Vehicle must be in park to complete pairing process.

4. Input the Passkey.  
(The initial passkey is 0000.)

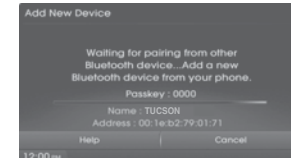

5. Bluetooth® becomes connected.

## BLUE LINK TELEMATICS SYSTEM

Press the button for access to the voice-response menu of services.

You have two options:

- You can say, "Main Menu" for a listing of main menu choices.
- You can directly select any of the listed menu items by saying its name.

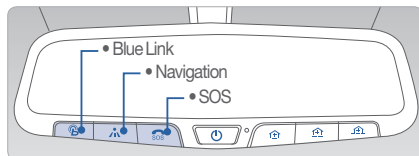

- Press the button for navigation-related services.
- Press the button for SOS Emergency Assistance.
- Refer to your Blue Link User's Manual for detailed information on system operation.
- For immediate assistance with subscription services, please call 1-855-2BLUELINK (1-855-225-8354).
- Please register your Blue Link at [www.MyHyundai.com](http://www.MyHyundai.com).

You must be an active Blue Link subscriber or within the initial free trial period to receive Blue Link services, including emergency notification services.

## Remote Door Unlock/Lock

### Blue Link Mobile App



You can download the Blue Link mobile app to your compatible smart phone from the following sites:

- iPhone® — Apple® App Store
- Android® — Google Play

With this feature, you can lock or unlock your vehicle doors from virtually anywhere by using the Blue Link mobile phone app, by dialing the toll-free number, or by using the Blue Link owner's website.

- To use this feature, you must have a Blue Link Personal Identification Number (PIN). To create or change your PIN, log on to [www.MyHyundai.com](http://www.MyHyundai.com).

### To Activate Remote Door Unlock/Lock

- By Blue Link Mobile App: Select DOOR UNLOCK or DOOR LOCK, as desired.
  - Enter your Blue Link PIN.
  - The command to lock or unlock your doors will be sent to your vehicle.
- By phone: Dial toll-free 1-855-2-BLUELINK (1-855-225-8354).
- By web site: Log on to [www.MyHyundai.com](http://www.MyHyundai.com), select the Blue Link logo on the upper left-hand side.
  - Select Vehicle Status, then Remote Door Unlock/Lock.
  - Input your Blue Link PIN. (If you need time to get to your vehicle, specify a time delay before your vehicle will be unlocked.)

## STANDARD RADIO

### Audio mode

#### Type A

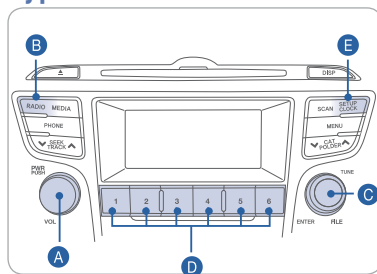

#### Type B



Press POWER button **A** to turn radio on.

#### • TUNING / LISTENING TO CHANNELS

1. Press RADIO button **B**.
2. Turn the TUNE knob **C** to select the desired channel and press the knob.

NOTE A clear view of the southern sky helps to ensure XM<sup>®</sup> radio reception.

#### • SETTING PRESET MEMORY BUTTONS (FM/AM/XM<sup>®</sup>)

Press and hold any preset button (1-6) **D** to store current channel.

#### • ADJUSTING THE SOUND CONTROL

1. Press the SETUP button **E**.
2. Select "Sound Settings" by turning and pressing the TUNE knob **C**.
3. Select "Bass," "Middle," "Treble," "Fader," or "Balance" by turning and pressing the TUNE knob **C**.
4. Adjust the sound by turning and pressing the TUNE knob **C**.

## NAVIGATION

### Audio mode



Press POWER button **A** to turn radio on.

#### • TUNING/LISTENING TO CHANNELS

1. Press FM/AM **B** or XM<sup>®</sup> **C**.
  2. Rotate Audio Control knob **D** to desired channel.
- NOTE A clear view of the southern sky helps to ensure XM<sup>®</sup> radio reception.

#### • SETTING PRESET MEMORY BUTTONS (FM/AM/XM<sup>®</sup>)

Press and hold any preset button (1-6) **E** until audible beep is heard to store current channel.

#### • ADJUSTING THE SOUND CONTROL

1. Press INFO SETUP **F** button and press the SETUP and press the SOUND to display the Sound Settings screen.
2. Touch on-screen arrows to adjust desired setting.



## AUX, USB AND iPod PORT

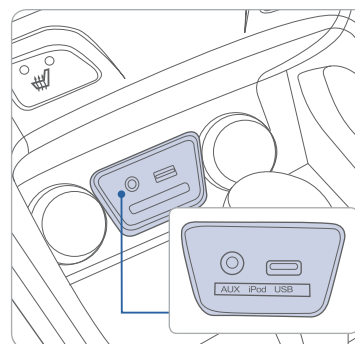

Use the jack to connect an external audio device and listen to it through the audio system in your vehicle.

### NOTE

To operate your iPod<sup>®</sup> through the vehicle's audio system, use the cable provided with your ipod device.

iPod<sup>®</sup> is a trademark of Apple, Inc.

## NAVIGATION

### Map position

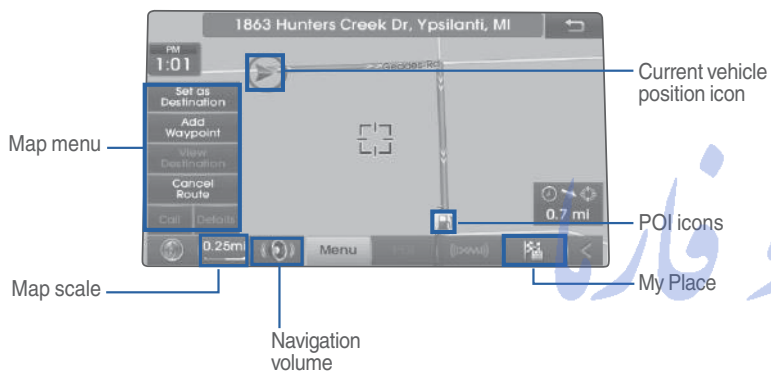

### Destination menu

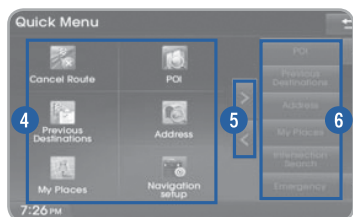

#### Quick Menu

Press the button on the left side of the map screen to display the Quick Menu.

1. Quick Menu – Display/hide Quick Menus
2. Quick Menu Bar – Menus added to the Quick Menu (possible to set up to 6 menus)
3. Edit - Add/Delete Quick Menus
4. Current Quick Menus – Shows list of current Quick Menus
5. Add/Remove – Add or remove Quick Menus
6. Quick Menu Categories – List of categories that can be added to Quick Menus

### Destination menu

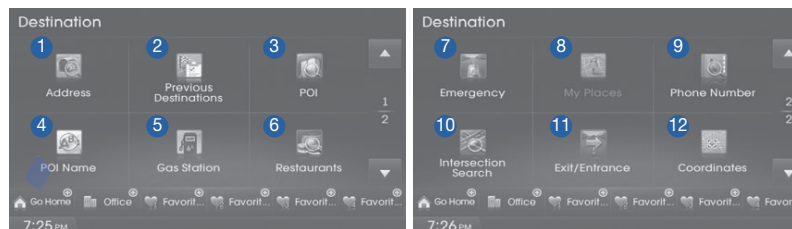

Name	Description
1 Address	Used to search destinations by selecting specific states/cities/roads
2 Previous Destinations	Used for route guidance to recently set destinations
3 Point of Interest	Used to search for neighboring POIs near current position/near scroll position/near destination/near city center
4 POI Name	Used to search for POIs by name
5 Gas Station	Used to search for gas stations
6 Restaurants	Used to search for restaurants
7 Emergency	Used to make emergency related searches
8 My Places	Displays list of saved My Places
9 Phone Number	Used to search destinations by entering POI phone numbers
10 Intersection Search	Used to search destinations by selecting street intersections
11 EXIT/Entrance	Used to search destinations by searching for expressway exits/entrances
12 Coordinates	Used to search destinations by entering the Lat/Long coordinates



## CLOCK ADJUSTMENTS

### Type A

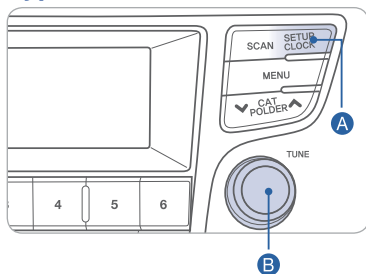

With Type A or B Radios:

1. Press and hold the SETUP/CLOCK (A) button.
2. Select "Clock Settings" or "Time Format" by turning and pressing the TUNE/ENTER (B) knob.
3. Set the time in "Clock Settings" by turning and pressing the TUNE/ENTER (B) knob.
4. Select the time format in "Time Format," 12 hour format or 24 hour format, by turning and pressing the TUNE/ENTER (B) knob.

### Type B



With Navigation:

Press and hold CLOCK (A).  
GPS Time received from the GPS will be displayed automatically.  
Time Format: When the clock type is digital, it converts the time display between 12 hour and 24 hour format.

## AUTOMATIC TRANSMISSION

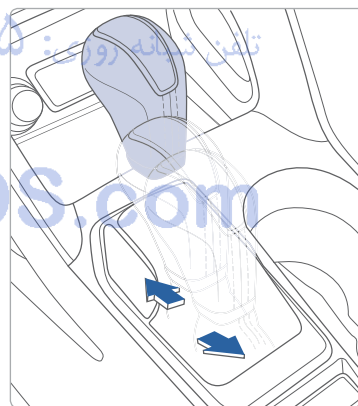
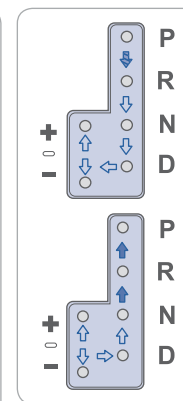
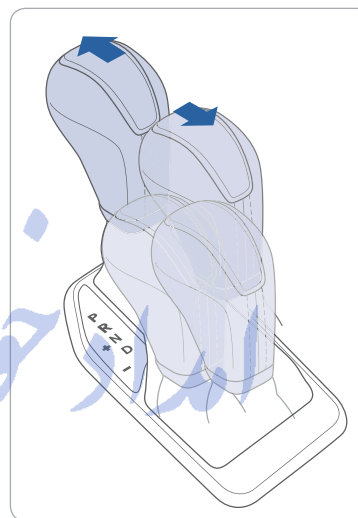

### Sport mode

Move the shift lever from D (Drive) into the manual gate to select.  
Move the shift lever forward (+) to upshift or rearward (-) to downshift.

## TIRE PRESSURE MONITORING SYSTEM (TPMS)

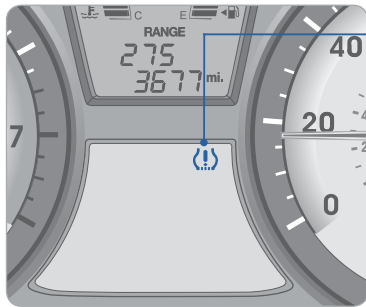

Low Tire Pressure Indicator /  
TPMS Malfunction Indicator



### LOW TIRE PRESSURE INDICATOR

Illuminates if one or more of your tires is significantly under-inflated.

### TPMS MALFUNCTION INDICATOR

Blinks for approximately one minute, then remains illuminated when there is a malfunction with the TPMS. Inspect all tires and adjust tire pressure to specification. If the lamp remains illuminated, have the system checked by an authorized Hyundai dealer as soon as possible.

## ELECTRONIC STABILITY CONTROL (ESC)

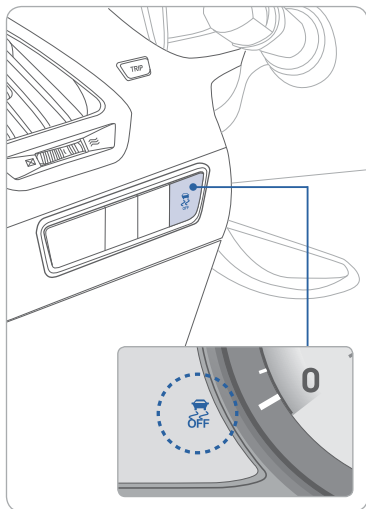

The ESC system is an electronic system designed to help the driver maintain vehicle control under adverse conditions.

- To turn the ESC off, press the ESC OFF button.
- ESC off indicator will display in instrument cluster.
- To turn ESC on, press it again.
- System defaults to ON position at start.



## ECO SYSTEM

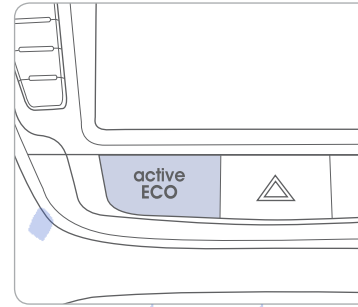

### Active ECO system

Active ECO system modifies the engine, transmission, and air conditioning operation for improved fuel economy.

Active ECO on – For optimal fuel efficiency

Active ECO off – For optimal performance and drivability.

When Active ECO activated, the transmission may upshift at lower speeds and require more throttle input to downshift.

### To improve your fuel efficiency:

- Drive smoothly, accelerate at a moderate rate.
- Avoid full throttle shifts.
- Maintain steady cruising speed.
- Adjust your speed to the traffic to avoid unnecessary speed changes. Take care of your tires, keep them inflated to the recommended pressure, use the TPMS to prevent low pressure and excessive tire wear.
- Don't let the engine idle longer than necessary.
- Avoid unnecessary braking.

## AWD LOCK

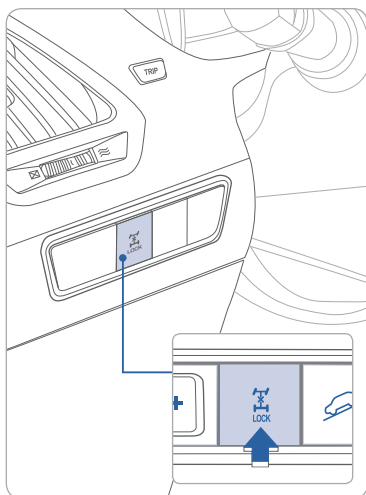

During off-road or inclement weather conditions, press the AWD LOCK switch to drive in full-time AWD. This will divide the power between the front and rear wheels (only when the vehicle speed is under 19 mph). The AWD LOCK indicator light on the instrument cluster will illuminate.

## REARVIEW CAMERA

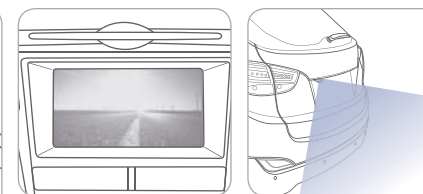
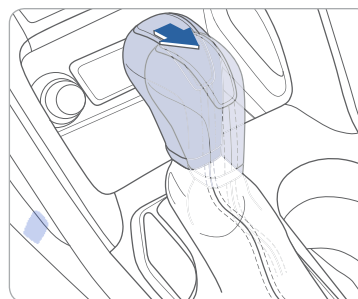

The rearview camera will activate when the ignition switch is ON and the shift lever is in the R (Reverse) position.

## Power outlet

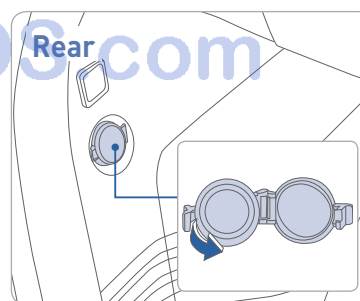
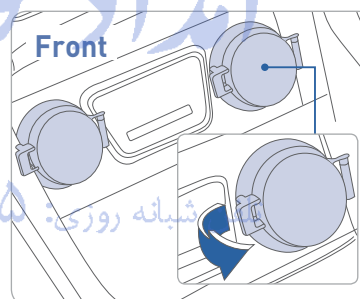

## DOWNHILL BRAKE CONTROL (DBC)

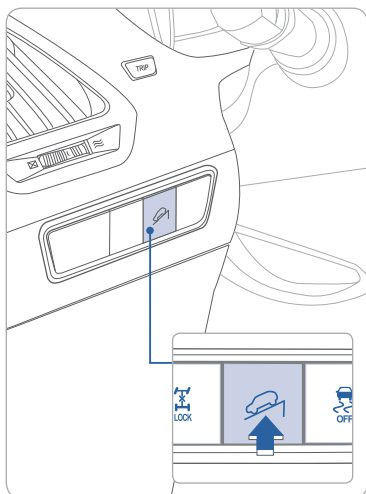

The Downhill Brake Control (DBC) helps the vehicle maintain a slow speed on a steep hill without the driver depressing the brake pedal.

### NOTE

When activated, vehicle speed will be reduced. Please refer to your Owner's Manual for further information.

The ignition switch or Engine start/stop button must be in the "ACC" or "ON" position to be used.

## KEY WEBSITES

Hyundai website - [www.hyundai.com](http://www.hyundai.com)

Hyundai owner website - [www.myhyundai.com](http://www.myhyundai.com)

Bluetooth phone compatibility - [www.hyundaiusa.com/bluetooth](http://www.hyundaiusa.com/bluetooth)



MEMO



## TUCSON CUSTOMER DELIVERY CHECKLIST

HYUNDAI OWNER	DEALERSHIP NAME
SALES CONSULTANT	DATE
VIN	PREVIOUS VEHICLE

## BEFORE DELIVERY

- ☐ CONFIRM "GOOD BATTERY" USING GR8 AND STAPLE TEST TICKET HERE
- ☐ SET TIRE PRESURE LF\_\_\_ RF\_\_\_ RR\_\_\_ LR\_\_\_
- ☐ VERIFY VEHICLE IS CLEAN, IN GOOD CONDITION, FREE OF CHIPS AND SCRATCHES · CLEAN WINDSHIELD AND BACK WINDOW
- ☐ ENSURE FLOORMATS ARE SNAPPED INTO PLACE

امداد خودرو فارما

تلفن شبانه روزی: ۰۲۱-۸۸۸۶۲۰۸۵

FarmaSOS.com

Sales Consultant	Date	Sales Manager	Date
Customer		@	Date
Email			